

Cooper Center for Active Living Newton, MA

Furniture Images

April 23, 2024

FIRST FLOOR PLAN

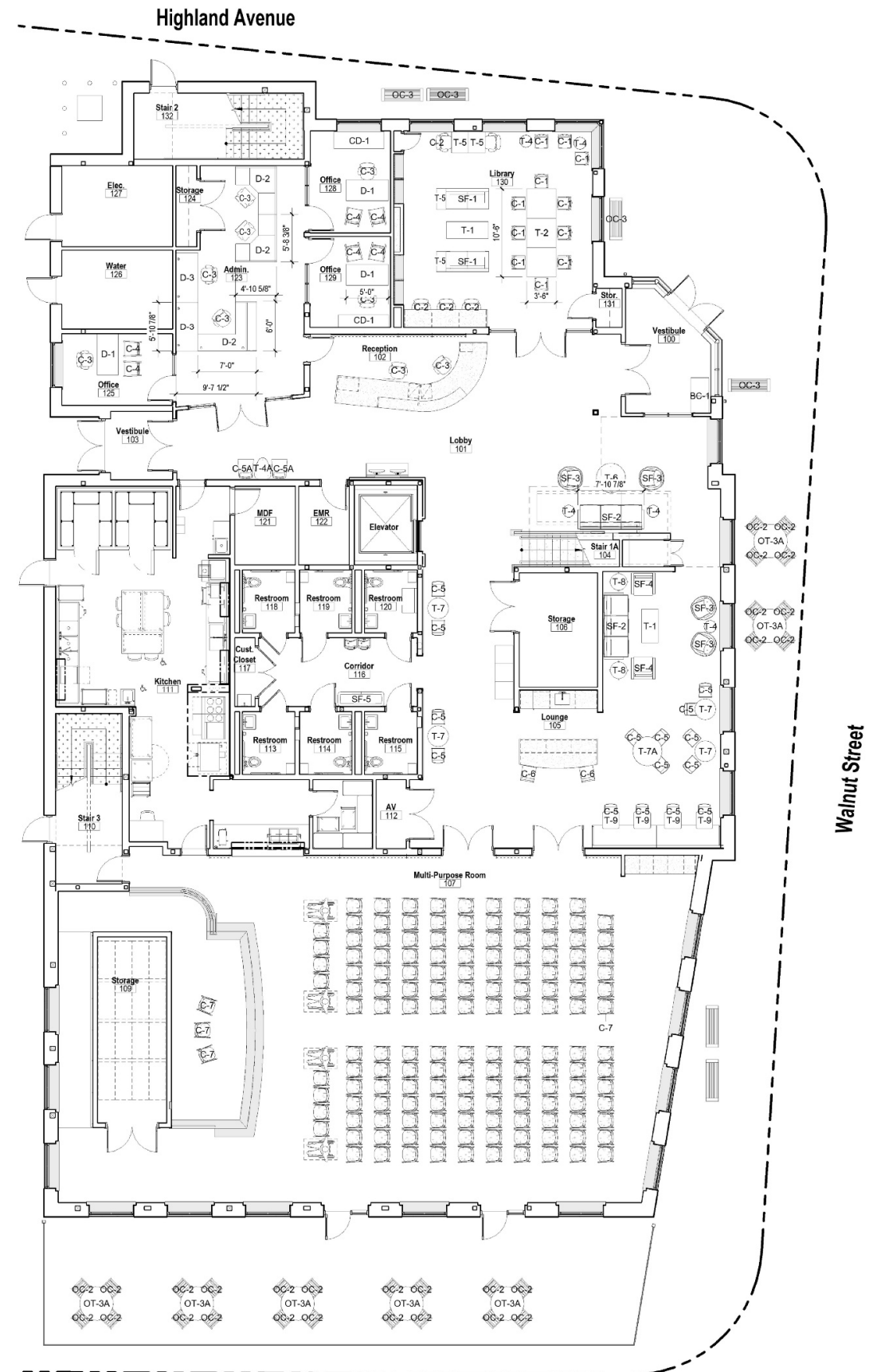

SECOND FLOOR PLAN

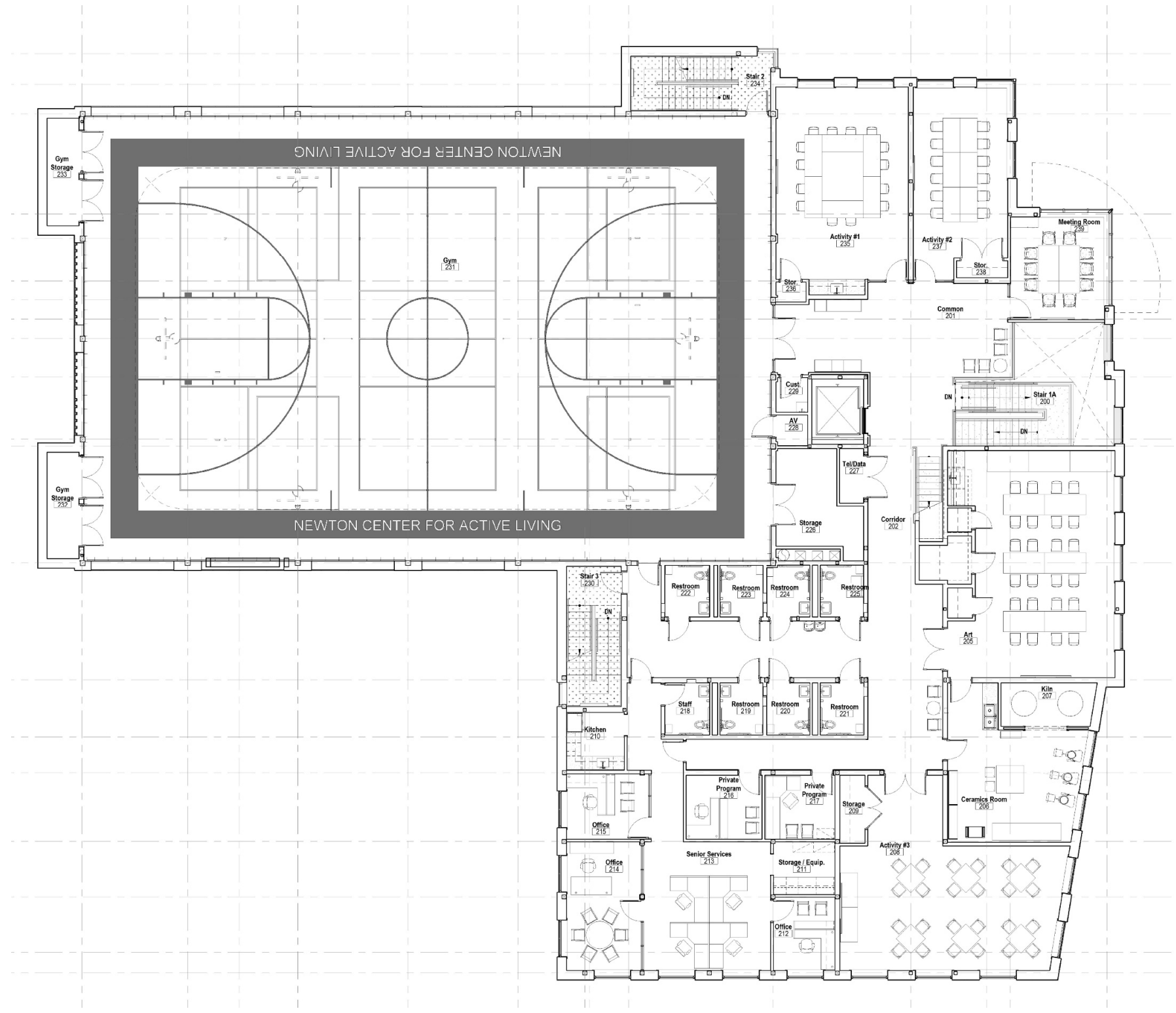

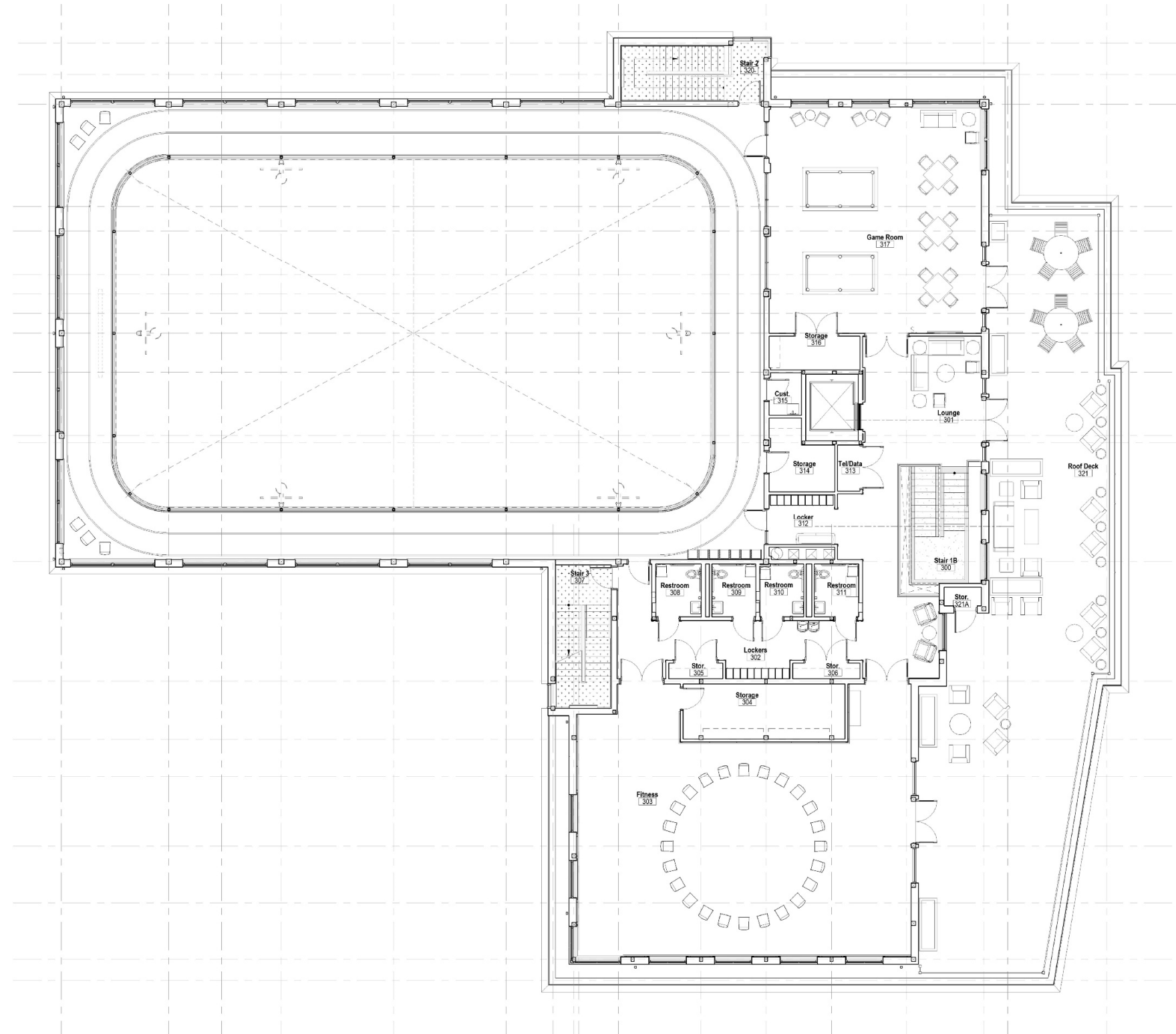

THIRD FLOOR PLAN

NewCAL Furniture Schedule
4/1/2024

	2024												2025					
	April					May				June			April	May	June	July		
	1	8	15	22	29	6	13	20	27	3	10	17	24					
Preliminary Furniture selection	█																	
Working Group session #1	█																	
Working Group session #2			█	█														
Showroom visits (To be Confirmed)	▨																	
Final Selections for bid documents						█												
Working Group session #3						█												
Bidding and Procurement										█								
Delivery and Install																█		

SCHEDULE





West Elm Sterling Lounge Chair



Blu Dot
Paramount 80" Sofa
80" w x 3" d x 32" h
Original price:

Current price:
Special Price

LOUNGE OPTIONS



LOUNGE OPTIONS

Kimball Collette shown in Architex Ultracrush Pitt; Legs: Iron/Bloom shown in Florence Duomo; Base: Light Brushed Aluminum

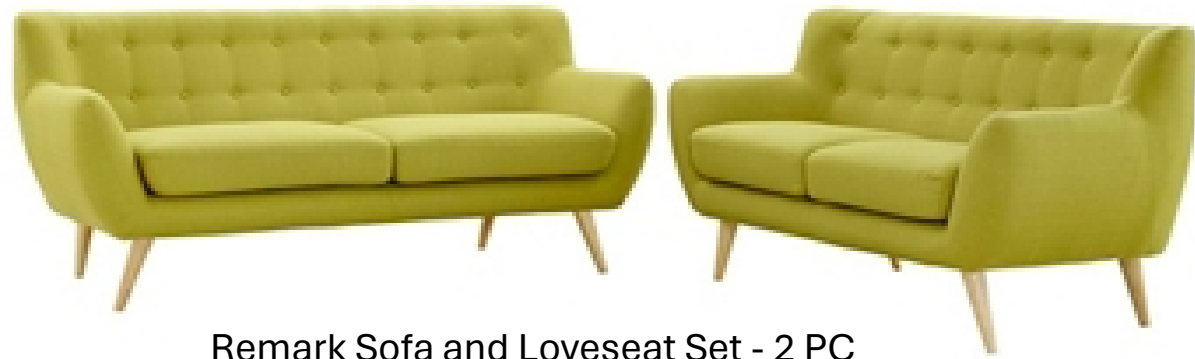

Remark Sofa and Loveseat Set - 2 PC
Product #: 220896



Upholstered Loveseat
Product #: 220394

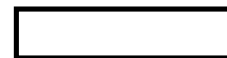

LOUNGE OPTIONS



Armchairs and Sofa Set of 3
Product #: 220556





Global Collingwood
 Low Back Lounge Chair
 GC36510
 55 lbs.



Lesro
 Siena Oversized
 Guest Chair
 Model: LSR-1201SN
 Office Chairs USA



Parkside Loveseat - 50"W
 Product #: 53608



Parkside Guest Chair in
 Faux Leather - 27"W
 Product #: 54968

LOUNGE OPTIONS



KI Affina Series Wood Armchair
 Durable Leather Upholstery
 Timeless Appeal
 Wood Legs and Arms In Designer
 Finish Options
 Matching Components Available
 Commercial Quality
 24 3/4"W x 23 1/2"D x 31 1/2"H

[] (Office Anything)



Stylex Cove
 Lounge Chair
 36"w x 30.5"d x 30"h
 Four-Blade Aluminum Base
 Fixed-Height 360° Swivel Return
 Textile from []



Stylex Cove
 Lounge Chair
 36"w x 30.5"d x 30"h
 Four-Blade Wood
 Capped Base, swivel
 Textile from []
 Leather from []

LOUNGE SIDE CHAIR OPTIONS



Global Erin

LOUNGE OPTIONS



Global Drift™ Side Chair, Wood Swivel Base (8031)



Global Erin™ Armchair, Wood Legs (GC36532)



Bloom®
BY KIMBALL

LOUNGE SIDE CHAIR OPTIONS



Global

Series Name: Drift™

Model Name: Low Back Lounge, Wood Swivel Base (8033)

Model Code: 8033, UL61, UL61, ~DL, NEM

Options: Back Textile {10|04}: Grade 08 ~08

Grade 08 Textile {GR}: Ultraleather Pro (Ultra Fabrics) ~ULPR

Ultraleather Pro (Ultra Fabrics) {FR}: 1-Mortar UL61Thumbnail for undefined

Seat Textile {10|10}: Grade 08 ~08

Grade 08 Textile {GR}: Ultraleather Pro (Ultra Fabrics) ~ULPR

{FR}: 2-Mortar UL61Thumbnail for undefined

Base Finish: Drift Wood Leg Finish ~DL

Base Finish {50}: F-Noce Leggero, Wood Leg Finish NEM NEM

Glide Type {65}:

Sealed Seam Back {01}:

Sealed Seam Seat {02}:

LOUNGE OPTIONS



Mason Street Wood Armless Guest
Chair in Fabric
Product #: 75808



Mason Street Wood Fabric Guest Chair
Product #: 75802



Wide Arm Chair - 26.5\"/>A simple black-outlined rectangular box, likely a placeholder for a color swatch or additional information.

LOUNGE SIDE CHAIR OPTIONS



Amherst Vinyl Two-Seat Bench
Product #: 75574 From: Lesro Collection: Amherst
Dimensions: 49"Wx21"Dx21"H



Blu Dot Branch Bench
60"w x 16"d x 18"h



Blu Dot
Chip Bench
50"w x 19"d x 27"h
Weight
40 lbs

BENCH OPTIONS

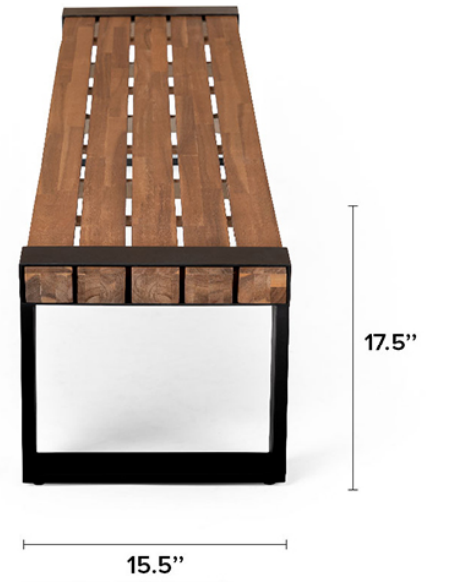
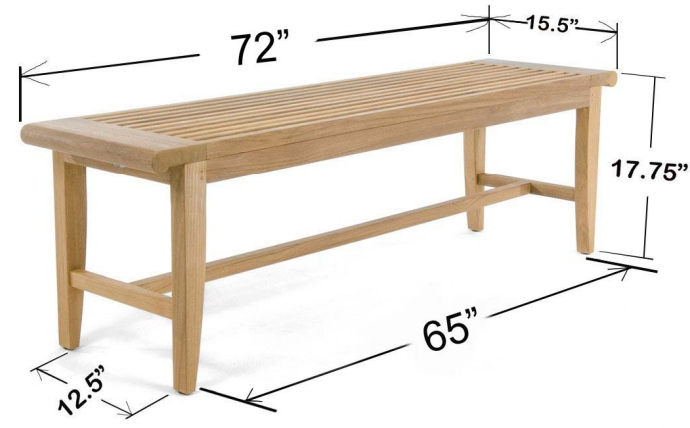

Article
 Lubek Tuscan Brown Bench
 Crafted from solid acacia wood
 indoors or out
 Powder-coated steel legs in a modern
 square shape add an industrial feel,
 while the natural wood warms up the
 look.



Westminster Teak 13917 - 6 ft Laguna Teak Backless Bench - Also Available in 3ft, 4ft & 5ft Lengths



BENCH OPTIONS



WEST ELM
 Volume Drum Coffee Table, 44", Cool Walnut
 \$799.00
 40" Round Pedestal Coffee Table
 Overall product dimensions: 40"diam. x 16.5"h.
 Base dimensions: 28"diam. x 15.1"h.
 Table apron: 4"h.
 Product weight: 59.5 lbs.
 Overall weight capacity: 100 lbs.



All Modern
 Fenway Coffee Table

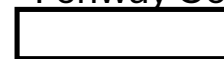

TA-8

LOUNGE COFFEE TABLE OPTIONS



West Elm Round Side Table
SKU: 693322
Set of 2

West Elm Contract Grade
Stowe Living Room Collection
Kiln-dried solid mango wood in a
Dark Walnut finish.

Stowe Cool Walnut 36 Inch
Round Coffee Table
SKU: 5004033



Rectangle Coffee Table
SKU: 4957524
Select finish: Cool Walnut

LOUNGE TABLE OPTIONS



Fairfield Anthony Arm Chair
L-8741-04



Armless chair
8740-05
Width: 22.50
Depth: 25.00
Height: 33.50
Arm height: 20.00

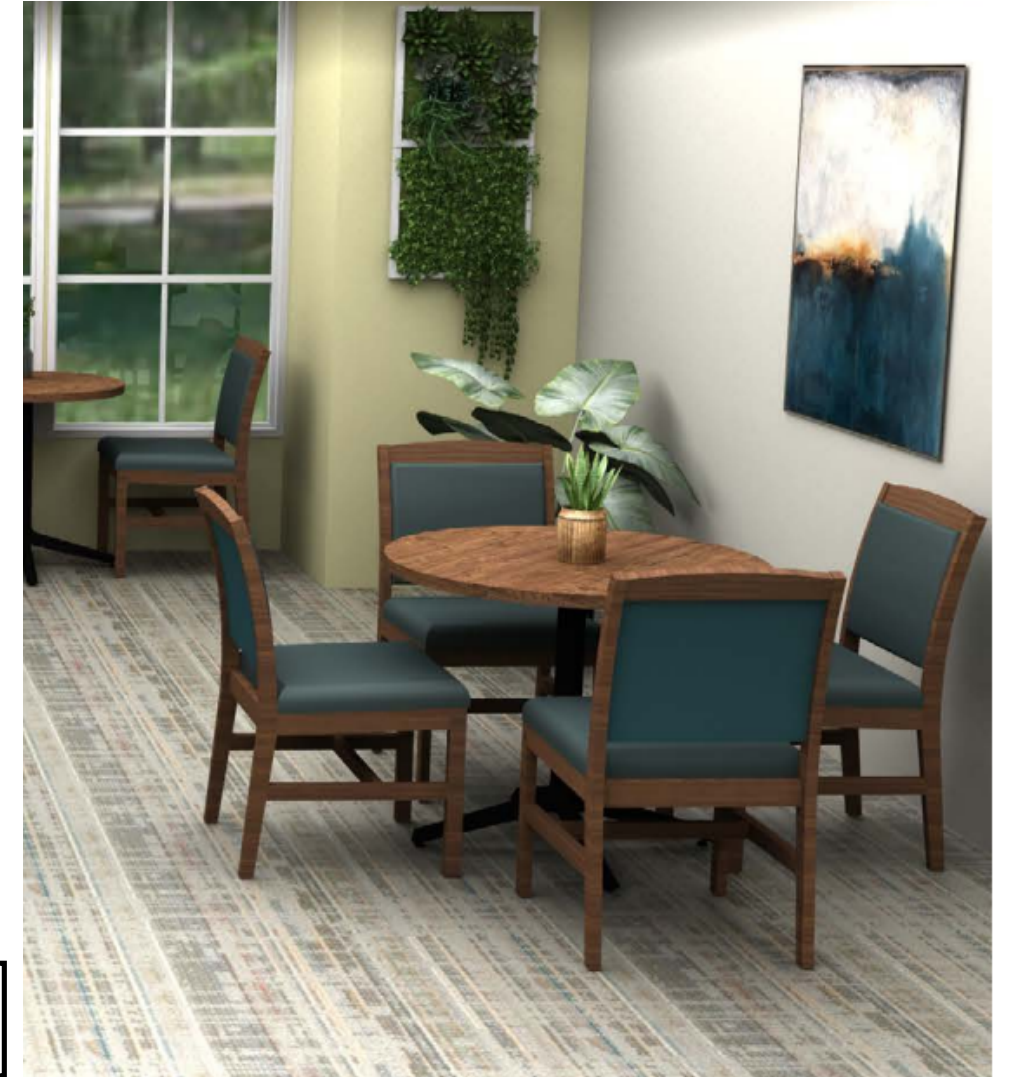

Width: 24.00
Depth: 26.00
Height: 33.00
Arm height: 24.50
Materials: Beech Solids
Finish options:
Standard Upholstery
Finishes and
FairShield+ Finishes



GAME ROOM CHAIR OPTIONS



Acquaint by National



Tucker by National

GAME ROOM CHAIR OPTIONS



GAME ROOM OPTIONS



Fairfield Commercial
CRESCENT
Crescent Activity and Dining Table
4179-86
Commercial grade laminate in Suede
finish with Nickel ferrules.
Materials: High Pressured Laminate with
solid wood
Finish: Suede



Fairfield Commercial
CRESCENT, LAMINATE
Crescent Activity and Dining Table
4171-86
Width: 42.00Depth: 42.00Height: 30.00
Commercial grade laminate top and solid wood edges finished in
Graystone with Nickel ferrules.
Materials: High Pressured Laminate with solid wood
Finish: Graystone



TABLE OPTIONS



Blu Dot Chip
Counter Stool
Slate Leather seat,
Walnut Legs



Overall
18”w x 20”d x 34”h
Weight
16 lbs



SideBySide
Chair



Blu Dot
SideBySide
Wood Chair
\$295
Overall
19”w x 20”d x 31”h
Seat
17”w x 17”d x 18”h
Back
18”w x 0.5”d x 13”h
Leg - 16”h



Blu Dot
Clean Cut Chair



19”w x 18”d x 31”h



CAFÉ SEATING OPTIONS

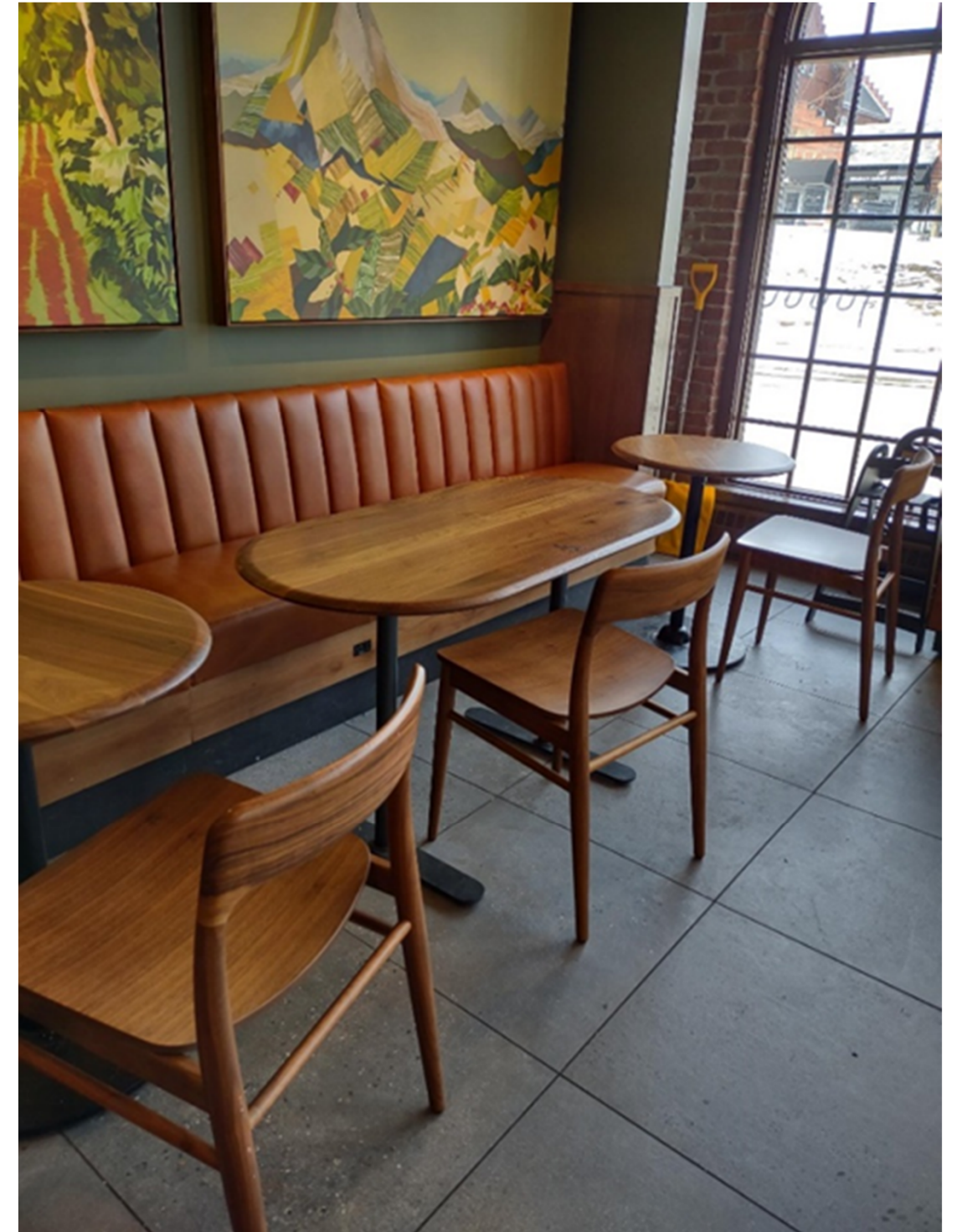

CAFÉ OPTIONS



West Elm
Sterling Counter Stool
[redacted]
Overall: 26.25"diam. x 38"h
Seat height: 26"
Seat depth: 17"
Seat width: 17.5"



Blu Dot Chip Counter Stool
[redacted]
18"w x 20"d x 34"h
Weight
16 lbs
Fabric seat
White Oak legs



Host Dining Chair
by Blu Dot
[redacted]

CAFÉ SEATING OPTIONS



Blu Dot
Host Dining Chair

Chip Chair



Urban Loft Standard Height Pedestal Table -
30"Wx29"H
Product #: 222063 From: KFI Studios



CAFÉ TABLE OPTIONS



Superior Seating
 SKU: TSW-PL
 Custom Solid Beechwood Premium Plank
 Table Top



Superior Seating
 Solid Ash Plank Table Top 1 1/4" thick
 SKU: TWG-PL-AW
 24" x 30"
 30" round
 42" round
 30" x 60"

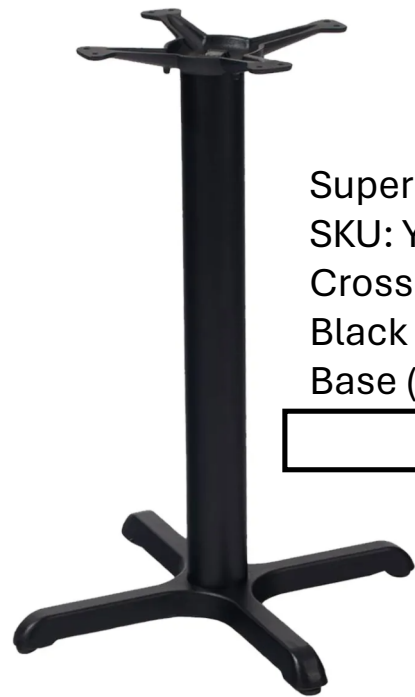

Superior Seating
 SKU: YO-BLK-3030
 Cross Cast Iron And Steel
 Black Commercial Table
 Base (30"x30")



CAFÉ TABLE OPTIONS



Easy Cafe Table by Blu Dot
White Oak tabletop: white oak veneers over wood,
solid white oak edging
Pedestal base: powder-coated steel in matte black or
matte white finish
30" round



Blu Dot
Chip Chair

18" w x 19" d x 30" h
14 lbs

Solid wood legs; ash with smoke stain, walnut, or white oak
Comfortable foam wrapped wood seat and back
Gunmetal / Pewter: Durable 100% Polyester fabric | 30,000 Double Rubs
Tait Stone: 90% Polyester / 10% Linen blend | 50,000 Double Rubs
Toohey Navy / Olive / Tomato: 97% Sunbrella Acrylic / 3% Other Fibers; Easy to clean
performance fabric | 100,000 Double Rubs
Sunbrella fabrics can be cleaned and sanitized using bleach or any additional
disinfectants without experiencing color loss or degradation.

CAFÉ TABLE OPTIONS



Easy Cafe Table by Blu Dot
30”l x 30”w x 29”h
56 lbs



West Elm
Orbit Restaurant Dining Table - Wood – Round
Oak veneer top over engineered wood with a solid oak edge.

Top 30”diam. x 29”h
Base 20”diam. x 28”h



Spec Acute Table
30D-XA 30” round
42D-XA 42” round
Top Laminate or Veneer
Bases are available in 76 Spectone colors

CAFÉ TABLE OPTIONS



West Elm Contract
Orbit Restaurant Dining Table - Wood - Rectangle

Overall: 32"w x 24"d x 29"h

Base: 20"diam. x 28"h

Comfortably seats: 4

Clearance: 28"

Overhang: 10.75"

Top thickness: 1"

Product weight: 60 lbs.



CAFÉ TABLE OPTIONS



Versteel Deci



CAFÉ TABLE OPTIONS



Versteel Performance table
Folding for storage



Portable, folding table for sign-in



Base Model:PINR1848T-74P
Pirouette:Rectangle
Leg Type:Standard (Training)
Surface Size:Small (18 X 48)
Base:Nested
Orientation:Standard
Feet:Caster
Height:Standard Height (29")

TABLE OPTIONS



Wayfair
 Dynalite 54" Circular Folding Table
 29" H X 54" L X 54" D
 Overall Product Weight
 85 lb.



Powder Coated Finish
 Yes
 Top Material
 Particle Board/Laminate
 Base Material
 Metal
 Wheels / Casters Included
 No
 Supplier Intended and Approved Use
 Residential Use; Non Residential Use



PS Furniture
 Scissor™ Vertical Fold-In-Half Rolling
 Tables
 One-of-a-kind center folding conference,
 dining, and multi-purpose table on casters

- Zero pinch points for safety
- Fits through doorways and in elevators
- 1" thick particleboard with HPL & Vinyl
 2MM Linear Edge
- Standard Height of all tables will be 29" high

TABLE OPTIONS – MULTI-PURPOSE ROOM



Versteel Performance 36" square table
Folds for storage



Base Model:
Pirouette:Square
Leg Type:X-Base
Feet:Glide
Height:Standard Height (29")



Urban Loft Standard Height Pedestal Table -
36"Wx29"H
Product #: 222155 From: KFI Studios

Crafted from the heartwood of the poplar tree.
Tabletop is 1.25" thick and sits atop a sturdy, 16-gauge cast iron base with a 3" diameter column.



Spec Acute

TABLE OPTIONS



Smythsystem Planner Studio Butcher Block fixed height with casters
KI Strive Chair



School Outfitters
Ideate Series Industrial Table w/ Butcher Block Top (31" H)
by Learniture®
| SKU: LNT-NOR3007BB-PK-SO

TABLE OPTIONS – ART ROOM



KI Tributaire Training Table



With optional modesty panel



PROGRAM ROOM TABLE OPTIONS



Nesting storage



KI Pirouette Tables



PROGRAM ROOM TABLE OPTIONS





Folding Tables

PROGRAM ROOM TABLE OPTIONS



ARMS



NO ARMS



Glide - Caster options

KI Strive Stack Chair with Arms

51290

Starting

Loop arms starting

POLYPROPYLENE SEAT AND BACK

For easy transportation and storage, Strive 4-leg and sled base chairs can stack 4-high on the floor. On a dolly, poly seats stack 15-high and upholstered seats stack 8-high. Caster chairs can stack 4-high on the floor.

KI Strive 4 Legged Stacker

KI-SLNAP

Starting

UPHOLSTERED SEAT OPTION

Starting



PROGRAM ROOM STACKABLE CHAIR OPTIONS

ARMS



Global Rebound Chair
an innovative multi-purpose chair, featuring a patented flex back that provides an unexpected level of support. Polypropylene shell available in 14 colors with matching arms.
20 eco-friendly, durable powder coated frame finishes or plated finish.
Stacks five high on the floor, 10 high on the dolly.

PROGRAM ROOM STACKABLE CHAIR OPTIONS



Arms, upholstered seat



Armless, upholstered seat



NO ARMS



Glide – Caster options

Armless with rubber non-slip glides



UPHOLSTERED SEAT
OPTION



ARMS



Global Stream Chair
Armchair, Polypropylene Seat & Back (2075APP)



NO ARMS



Global Stream Chair
Armless Chair, Polypropylene Seat & Back (2075NPP)



PROGRAM ROOM STACKABLE CHAIR OPTIONS

ARMS



Spritz™ Flip Seat Nesting Armchair,
Glides (6765)



NO ARMS



Spritz™ Armless Flip Seat Nesting Chair,
Glides (6764)



Spritz™ Armless Flip Seat Nesting Chair,
Casters (6764C)



Nesting and Multi-Purpose models feature an auto-adjusting comfort back. Spring loaded back reacts to body pressure and articulates 12°. Nesting chairs have a flip up seat allowing chairs to stack horizontally. Nesting chairs are standard with four Black nylon glides, C1 carpet casters or with two casters at front, two glides at rear.

PROGRAM ROOM NESTING CHAIR OPTIONS

ARMS



Herman Miller
Caper Stacking Chair

32" H 24¼" W 18½" D



Caper's glass-filled nylon seat and back are contoured for comfort, flexible for give, and colorful enough to brighten up any room. Holes in the material allow the body to breathe, so moisture and heat dissipate, and sitting is a cool experience.



Caper Stacking Chairs can stack six-high on the floor or 15-high on the Caper Cart

NO ARMS



32" H 24¼" W 18½" D



PROGRAM ROOM STACKABLE CHAIR OPTIONS



ARMS

KI Torsion Air
Four-Leg Arm Chair
Back flex
Mesh Back
Stacking
Fabric grade 3



NO ARMS

Tablet
Options

KI
Torsion Air Stack Chair
**UPHOLSTERED SEAT,
MESH BACK**

HRDPT
Transport Dolly for
four leg chairs

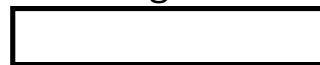

KI Torsion Air
Four-Leg Armless Chair
Back flex
Mesh Back
Stacking
Fabric grade 3
Delivered \$719

PROGRAM ROOM STACKABLE CHAIR OPTIONS



SitOnIt Rio Four Leg Series
Upholstered Seat
Armless, Floor Saver Glides



SitOnIt Rio Four Leg Series
Upholstered Seat
Fixed Arms, Floor Saver Glides



SitOnIt Rio Orbix
Wire Rod Plastic
Starting



SitOnIt Anytime Four Leg
Series
Plastic
Starting

PROGRAM ROOM STACKABLE CHAIR OPTIONS



SitOnIt Anytime Four Leg
Mesh back, upholstered seat



SitOnIt Anytime Four Leg
Mesh back, upholstered seat
ARM STYLE
Fixed Loop (silver)
GLIDES
Floor Saver Glide



SitOnIt Cora
Upholstered back and seat
Fixed Arms
Moisture barrier seat
Floor Saver Glide



SitOnIt Cora
Upholstered back and seat
Armless
Moisture barrier seat
Floor Saver Glide



PROGRAM ROOM STACKABLE CHAIR OPTIONS



Shelby Williams
 Aluminum Stacking Banquet Chair with Action Back
 Grade 3 Upholstery
 8678
 17.75"W x 20.5"D x 35.5"H, 18.25"SH, 15.75"SW
 14.00LB



BANQUET/ASSEMBLY CHAIR OPTIONS



Superior Seating SKU: BQT-1572-AL
 Atticus Square Back Stackable
 Aluminum Banquet Arm Chair



Flex-back	No
Frame Mat'l	Aluminum
Usage	Indoor
Stackable	Yes
Stacks High	5.00
Weight	28.50 Pounds
Height	37.00 Inches
Width	23.00 Inches
Depth	24.50 Inches
Seat Height	18.00
Seat Depth	20.00 Inches
Seat Width	20.00 Inches
Weight Capacity (approx.)	400 Pounds



Superior Seating SKU: BQT-2572-AL
 Atticus Square Back Stackable
 Aluminum Banquet Chair



Flex-back	No
Frame Mat'l	Aluminum
Usage	Indoor
Stackable	Yes
Stacks High	5.00
Weight	16.00 Pounds
Height	37.00 Inches
Width	23.00 Inches
Depth	24.50 Inches
Seat Height	18.00
Seat Depth	20.00 Inches
Seat Width	20.00 Inches
Weight Capacity (approx.)	400 Pounds



Mitylite
Regal Banquet Chair
Height: 38.2" Width: 18.5" Length: 23.3"
Weight: 16 lbs
Stacking Number of Chair: 6 chairs
Stack Height: 66.2"
Stack Depth: 34"

ARMS



Restaurant Equipment World

MTS Seating
MTS-594-AR-GR8

NO ARMS



Restaurant Equipment World

MTS Seating
MTS-594-GR6

BANQUET/ASSEMBLY CHAIR OPTIONS



TITAN EVENT FURNITURE™
Titan Series™ Wood folding table -
6'x30" banquet

Item #WFT26-3072

Color	Plywood
Material	3/4" Plywood
Shape	Rectangle
Size	6' x 30"
Commercial-Grade?	Yes
Folded Dimensions	2.25"
Legs	16 gauge, powder coated Steel
Overall Length / Depth	72"
Overall Height	30"
Overall Width	30"
Recommended Tablecloth Size	60"x102", 60"x126", 90"x132
Recommended Seating	6
Ships Assembled?	Yes
Product Warranty	1 Year Warranty
Weight Capacity	500+ lbs.
Item Weight	45 lbs



Mitylite
ABS Rectangle
Weight: 30 lbs (13.6 kg) - 61 lbs (27.7 kg)



ASSEMBLY FUNCTION TABLE OPTIONS



Mitylite
RT Cart – Edge
Height: 39.4" (100.1 cm)
Width: 30" (76.2 cm)
Length: 74.5" (189.2 cm)
Weight: 78 lbs (35.4 kg)

ASSEMBLY FUNCTION TABLE OPTIONS



Global Spyker Indoor Outdoor Stacking Chair / Carton of 4
GLB-6790-91

Office Chairs USA
Weight 6790 – 10 lbs., 6791 – 9 lbs.
Weight capacity – 275 lbs.
Dimensions: W23.5 x D21.5 x H31.5IN.



Stacks 10 high
on floor, 12 high
on dolly

OUTDOOR CHAIR OPTIONS



Landscape Forms
 Catena chair
 23”d x 21”w x30”h 15 lbs.

- The frame of the Catena chair is formed of 7/8" diameter aluminum.
- The seat is cast aluminum with a 17 1/2" seat height.
- Spindles are stainless steel.
- Chairs are stackable.

Finishes

- All metal parts are finished with Landscape Forms’ exclusive Pangard II® polyester powdercoat, a hard yet flexible, finishing process that resists rusting, chipping, peeling and fading.

Powdercoat Catena Table Top w/Other Support
 42" Square Catena Metal Top 42.0" x 29.0" ship weight 166 lbs. \$1430
 30" Round Catena Metal Top 30.0" x 29.0" 93 lbs.



Catena Chair 23.0" x 21.0" x 31.0" 25 lbs. \$650

42" Round Marneaux Solid Surface Table Top
 42.0" x 29.0" ship weight 195 lbs. \$2190
 30" Round Marneaux Solid Surface Table Top
 30.0" x 29.0" 145 lbs.

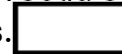

Single surface mounted base

Four base styles enable tables to be freestanding, surface-mounted or embedded, to meet individual project requirements.



Single surface mouted base
 with Solid Surface Marneaux®
 top option

Catena Base

Catena round tables feature a rolled edge and are available in 30", 36" or 42" diameters, in powdercoat or stainless steel metal.

Powdercoat Catena Table Top w/Catena Support
 42" Round Catena Metal Top 42.0" x 29.0" ship weight 242 lbs. 

OUTDOOR TABLE AND CHAIR OPTIONS



Chipman Table by
Landscape Forms
45" diameter table
x 29.25" high
85 lbs.
45.0" x 29.0" ship
weight 175 lbs.

Chair armless
22"d x 20"w x 33"h
17lbs.
Ship weight 67 lbs.

with arms
Ship weight 70 lbs.

22"d x 24"w x 33"h
20 lbs.

The Chipman line, designed by landscape architect Robert Chipman, includes a cast aluminum chair and stool of stunning sculptural form, and complimentary tables in lounge, dining and standing height versions. The tables have cast aluminum bases attached to a cast aluminum support tube.

- The support tube is bolted to a cast aluminum frame supporting a steel sheet top.
- The table features a unique surface/embedded mount system that allows for leveling adjustment.
- Dining table is available with or without umbrella hole.
- If used with umbrella, table must be surface mounted.
- All metal is finished with Landscape Forms' proprietary Pangard II® polyester powdercoat, a hard yet flexible finish that resists rusting, chipping, peeling and fading.
- Call for standard color chart.

Delicate in scale and proportion, it is heavy enough for rooftop terraces but light enough to move around. The one-piece cast chair seat and back has seamlessly welded on legs and arms; the table has a flat aluminum top encircled by a tapered cast rim and an inverted cone-shaped stem with feet.



Parasols by TUUCI – Ocean Master Classic Hexagon
109"d x 125.5"w x 100"h
10' Hexagon Parasol 109.0" x 126.0" x 99.0" ship weight 26 lbs.

OUTDOOR TABLE AND CHAIR OPTIONS



Landscape Forms
21 Chair designed by
Modello USA.

Chair armless

25.5”d x 25.75”w x 32.75”h

23 lbs.

With arms

25.5”d x 28”w x 32.75”h

25 lbs.

It’s metal tube frame, chamfer-edged die-cast aluminum slatted seat and back, and 21-inch-wide seat create comfortable surfaces that invite multiple postures. The chair’s arms are angled for natural support. The chair comes with or without arms and can be stacked up to four chairs high.



OUTDOOR TABLE AND CHAIR OPTIONS



The 48" round dining table is constructed of teak with no finish. All tables have removable center teak plug. Table can be specified as surface mount, or freestanding. If used with an umbrella, table must be surface mounted for stability. Powdercoated titanium surface mount plate is attached to base. Black rubber center grommet comes standard with each surface mount table. Stainless steel leveling glides provided for freestanding tables. Some assembly required.

The chairs are available with or without arms and constructed of teak with no finish. The chairs have an overall height of 34" and ship fully assembled. Freestanding glides are standard on all chairs.

Landscape Forms

Wellspring goes mainstream with new teak furniture for relaxed social settings in hospitality, residential and protected public spaces.

Table 48" x 30"

Dining Table 48.0" x 30.0" ship weight 225 lbs.

Chairs

Armless 22" x 22" x 34"

With arms 23" x 22½" x 34"

w/Arms 23.0" x 22.5" x 34.0" ship weight 75 lbs.

w/o Arms 22.0" x 22.0" x 34.0" 75 lbs.

Side Table 25.0" x 24.0" x 24.0" ship weight

35 lbs.



- The litter is 22.5" square, 31.5" high and constructed of teak with no finish
- Litter features hinged powdercoated top lid for easy emptying
- Black polyethylene liner comes standard with each litter; litter ships fully assembled

22.5" x 31.5" x 20.0 Gal. ship weight 110 lbs.

OUTDOOR TABLE AND CHAIR OPTIONS



Westminster Teak
13883 - 6 ft Veranda Teak Bench

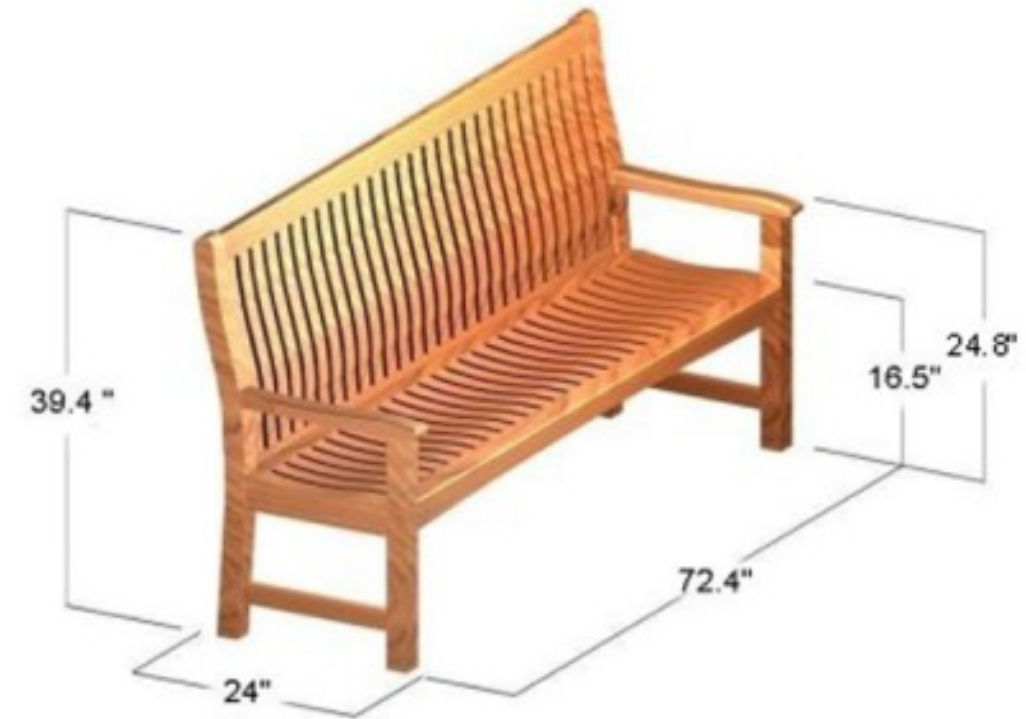

Benches are included in building documents and are anchored to concrete pavement per 4/L300

OUTDOOR BENCH



Westminster Teak 70483 - Veranda 4 ft Round Teak Dining Set - Round 48" Dia Table



12218 - Veranda Teak Armchair - Best Selling Chair



11315 - Veranda Teak Dining Chair - Best Selling Chair
21.5" L x 17.5" W x 36" H
16 lbs



SHOWN WITH OPTIONAL CUSHION

71011MTO - Sunbrella Chair Cushion - with Quick Dry Foam Core



15047 - 4ft Round Teak Dining Table - 48" Round Table



OUTDOOR TABLE AND CHAIR OPTIONS



Westminster Teak
 70418 - 7 pc Buckingham Laguna Dining Set - Round 72" Dia Table



OUTDOOR TABLE AND CHAIR OPTIONS



12810 - Laguna Teak Dining Armchair –
 Form Fitting Comfort



23" L x 22" W x 35" H
 32 lbs



15348 - Buckingham Teak Table -
 72" Round Table



11810 - Laguna Teak Side Chair -
 Form Fitting Comfort

23" L x 17.5" W x 35" H
 18 lbs





Westminster Teak
15867 - 5 ft Barbuda Table - 60 inch Round Foldable Table



17542F - 10 ft Round Umbrella - All Teak Construction



OUTDOOR TABLE AND UMBRELLA OPTIONS



12196 - Sussex Teak Chair -
Stacking Chair
[]
22.75" L x 21.25" W x 38" H
23 lbs

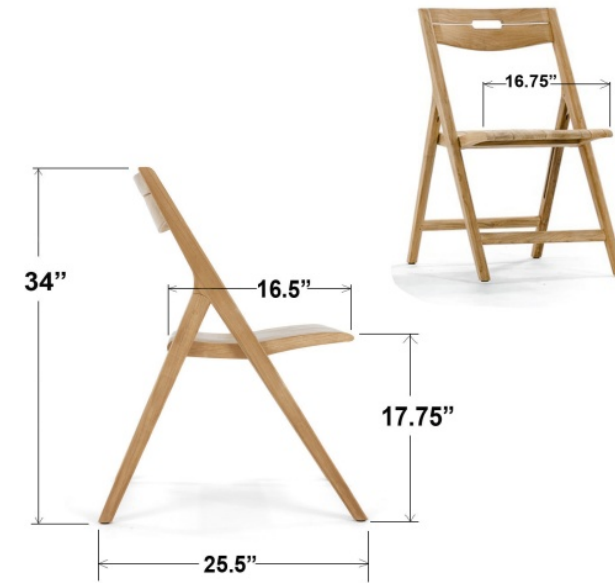

11901 - Horizon Teak Side Chair -
Elegant & Stackable
22" L x 19" W x 31.25" H
22 lbs
[]



11916 - Surf Chair - Folding
25.5" L x 16.75" W x 34" H 20 lbs.
[]

OUTDOOR CHAIR OPTIONS



14322 - Maya End Table - 38.75" L x 19.4" W x 11.5" H



Westminster Teak

70232 - Maya 6 pc Sofa Set - Quick Dry Cushions



OUTDOOR LOUNGE CHAIR OPTIONS



Westminster Teak
 70106 - Laguna 11 pc Lounge Set - Seats 5; Features Quick Dry Cushions



OUTDOOR LOUNGE CHAIR OPTIONS



14140 - Laguna Teak Side Table
 - 22" Diameter x 22" Height



14250 - Laguna Teak Coffee Table
 - 40" Diameter



12152DP - Laguna Teak Lounge Chair



34.5" L x 29.25" W x 32.5" H
 23.5" Inside Seat Width x 25.5" Inside
 Seat Depth
 12" Seat Height
 22.75" Arm Heightrest
 22.5" Inside Seat Depth
 Arm Width-2.75"



Westminster Teak
13152DP - Laguna Sofa –
66" L x 34.5" D x 32.5" H



12152DP - Laguna Teak Lounge Chair



34.5" L x 29.25" W x 32.5" H
23.5" Inside Seat Width x 25.5" Inside
Seat Depth
12" Seat Height
22.75" Arm Heightrest
22.5" Inside Seat Depth
Arm Width-2.75"



14140 - Laguna Teak Side Table
- 22" Diameter x 22" Height



14250 - Laguna Teak Coffee Table
- 40" Diameter

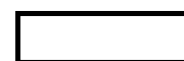

6 pieces totalled

OUTDOOR LOUNGE CHAIR OPTIONS



**Landscape Forms
Sorella Planters
15" x 15" x 30"**

- Planters available in rectangle or square shapes, in 18" and 30" heights.

- Fabricated, welded and ground steel panels attach to a recycled plastic base, with glides and optional drain holes.

- Planter bases and glides are compression-molded recycled plastic resulting from an innovative, patented melting process that utilizes 100% post-consumer and post-industrial waste.

- All metal is finished with Landscape Forms' proprietary Pangard II® polyester powdercoat, a hard yet flexible finish that resists rusting, chipping, peeling and fading.

- A wide range of standard, optional and custom colors are available.

15.0" x 15.0" x 30.0" 19.0 Gal. 39 lbs.
Ship weight 101 lbs.
Surface mounted



45"w x 30"d x 18"h 83.0 Gal. 96 lbs.
Ship weight 215 lbs.
Freestanding

30"w x 30"d x 30"h 89 Gal. 96 lbs.
Ship weight 165 lbs.
Freestanding

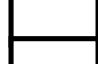

OUTDOOR PLANTERS

Landscape Forms
Kornegay Designs
Square Series Planters

SS-30 19.0" x 30.0" 440 lbs. 
SS-21 27.0" x 21.0" 495 lbs. 



The Square Series are four-sided precast concrete landscape containers with tapered radius sides. The planters ship with standard 2-3/8" diameter drainage, or custom holes to function with irrigation & drainage plumbing. The Square Series is available in 9 standard colors, with additional color mixing available, and can be finished in a bituminous sealer (suggested for interior applications) or sandblast finish.

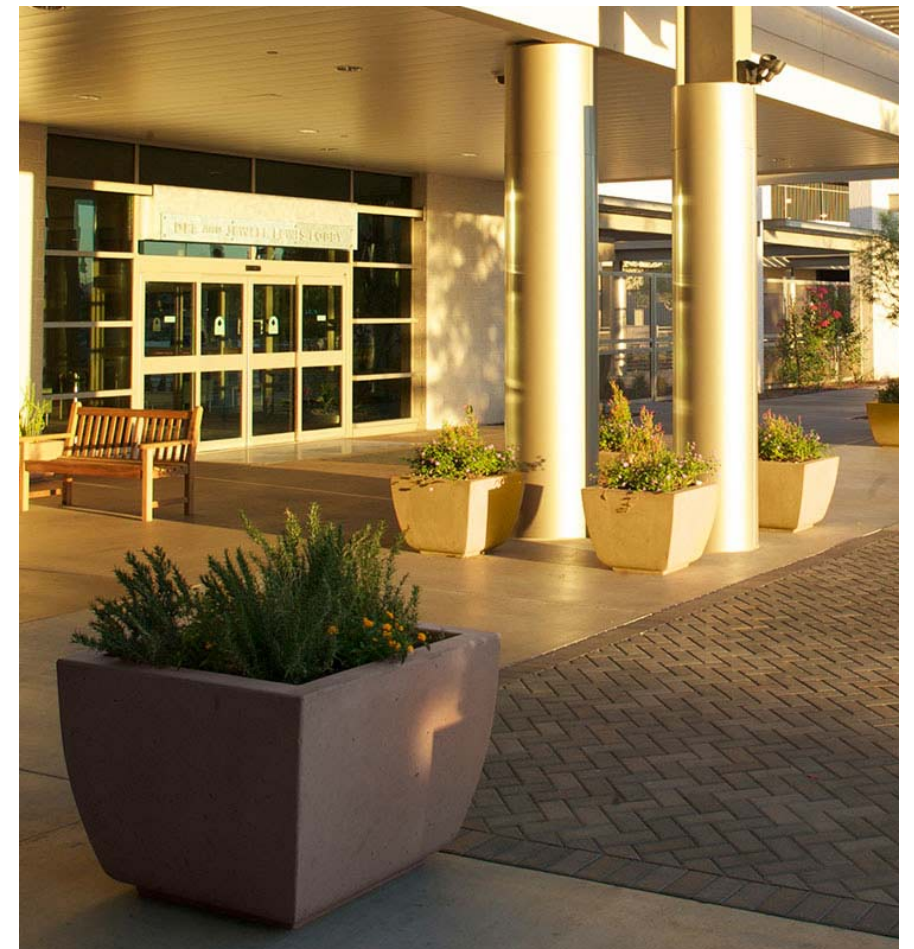
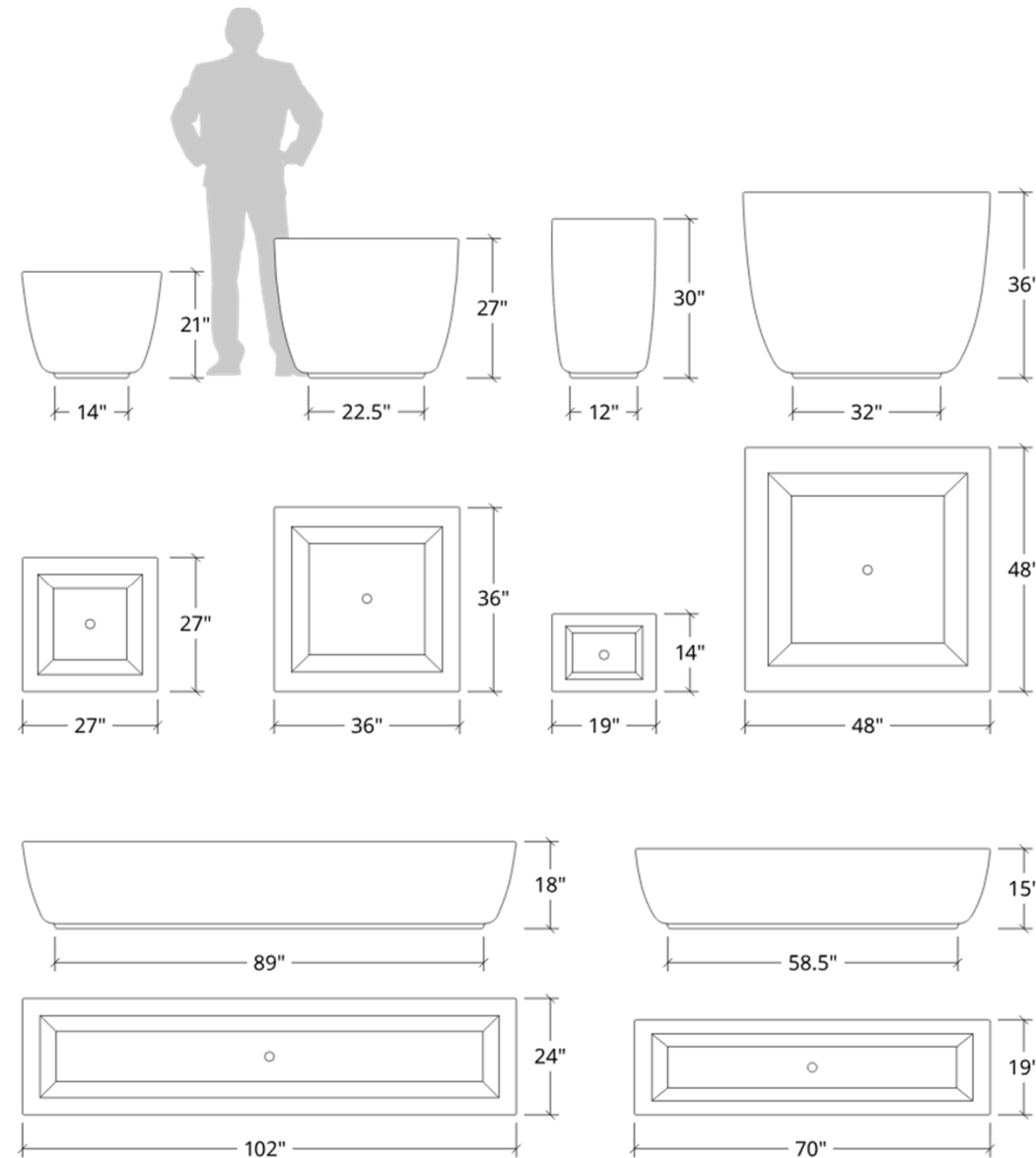

OUTDOOR PLANTERS

Landscape Forms
Kornegay Designs
ASPECT SERIES PLANTERS

Aspect is a series of four-sided precast concrete landscape containers with a minimal, architectural style and universal design appeal. Fine details like a simple shadow line at the base speak to Aspect's modest elegance and refined sensibility.

Aspect are commercial concrete planters with modern, understated silhouettes. Eight different sizes, ranging from 12" to 30" tall and 20" to 80" in diameter, fit different applications and form inspiring installations. The containers ship with the standard 2-3/8" diameter drainage hole, or custom hole to function with irrigation & drainage plumbing. The Aspect Series is available in 9 standard colors, with additional color mixing available, and can be finished in a bituminous sealer (suggested for interior applications) or sandblast finish.

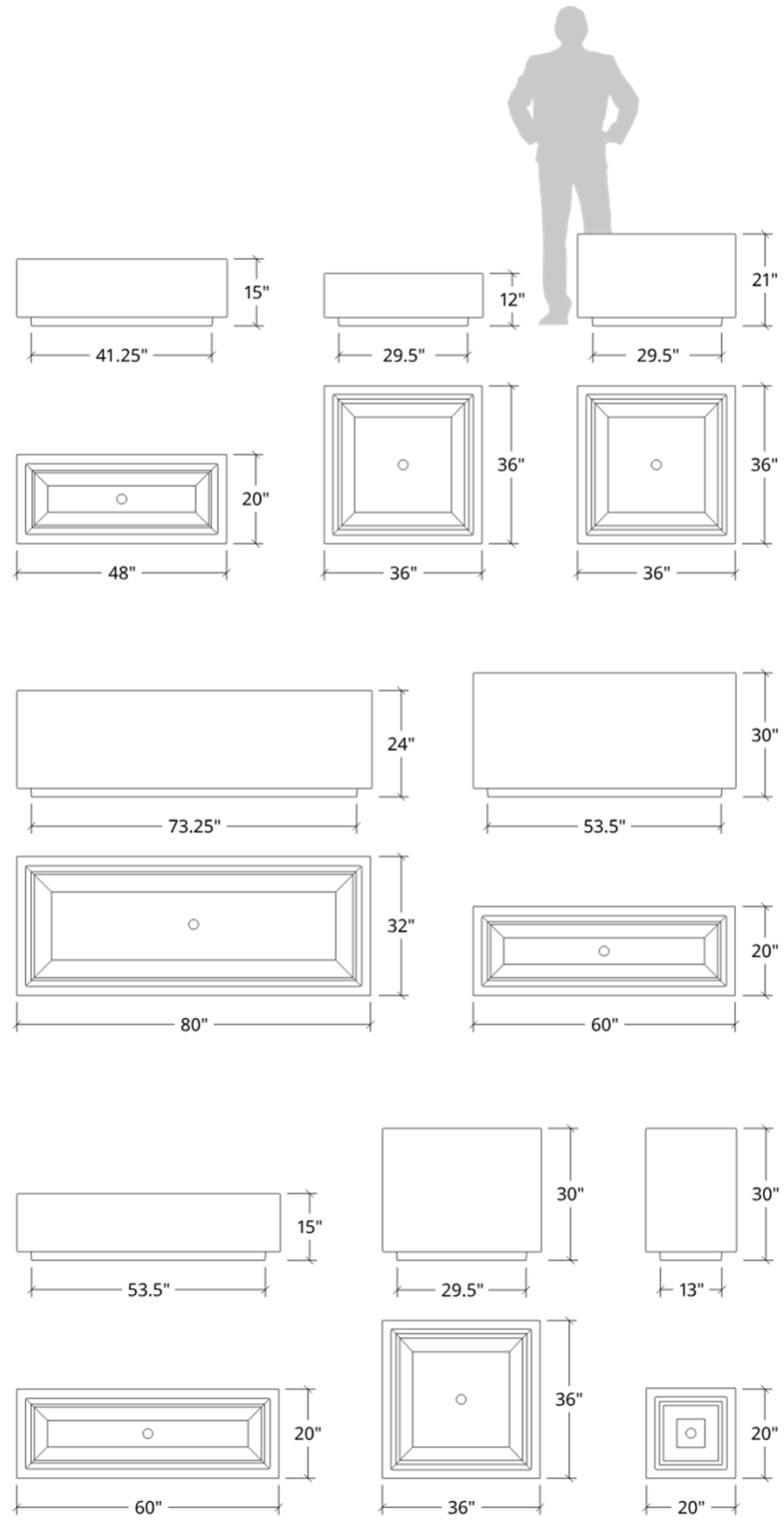

ASP-24
80" x 24" 73.25" base 1,935 lbs.



ASP-20
20" x 30" 13" base 530 lbs.

OUTDOOR PLANTERS



Urban Pot GEO Rectangle Fiberglass Planter

63"x24"x24"

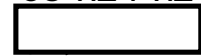

Urban Pot GEO Square Fiberglass Planter

M: 14" x 14" x 32"

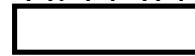

Urban Pot GEO Classic Fiberglass Planter

S: 16" x 16" x 20" H



M: 20" x 20" x 26" H



The GEO Classic Fiberglass Planter is a geometric shaped container with a pronounced rim at the top.

OUTDOOR PLANTERS



Urban Pot GEO Bowl

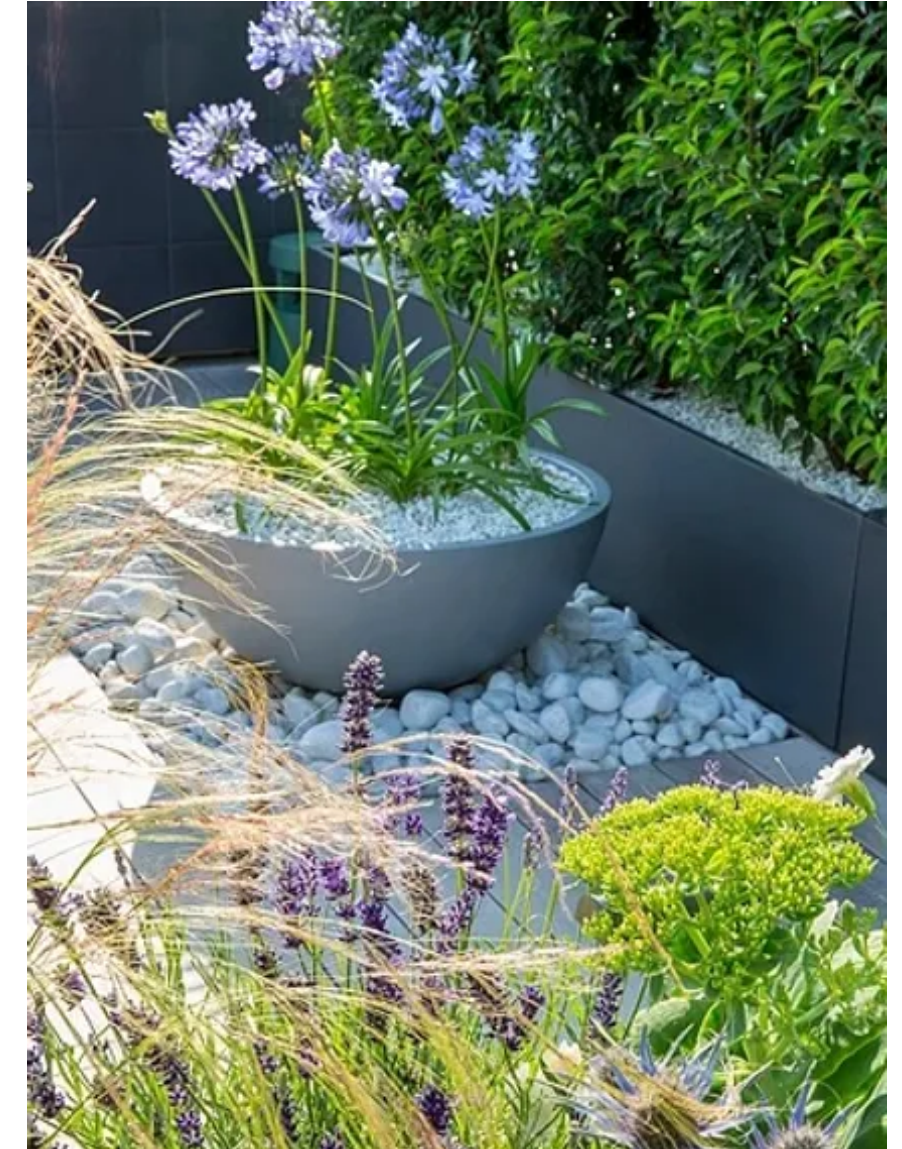

Urban Pot GEO Bowl Planter

M: dia 39" x 18" H



Bowl planters are frost-resistant and require little to no maintenance.

Comes with or without drainage holes.

OUTDOOR PLANTERS



Urban Pot Custom Planters

Mall example - The long planters on casters make it possible to create separate environments and provide areas of privacy and rest for customers.

We make our planters from a variety of different sheet metal, but generally use heavy gauge marine grade aluminum. Our choice is usually 1/8" thick 5052 aluminum alloy.

For custom-made planters, we use the process of electrostatic painting or baked paint (powder coat). Powder coating is an environmentally friendly coating process that creates zero VOCs and creates a durable, UV and impact resistant finish.

The choice is almost limitless. You can choose any color in the chart RAL

We make our planters from a variety of different sheet metal, but generally use heavy gauge marine grade aluminum. Our choice is usually 1/8" thick 5052 aluminum alloy.

All of our constructions are incredibly strong thanks to our "secret" manufacturing techniques which allow us to offer beautiful, robust products at competitive prices.

If required, we custom fabricate from thicker gauges of 5000 and 6000 series aluminum and also fabricate using stainless, corten and galvanized steels of various thicknesses.

OUTDOOR PLANTERS



Urban Pot Pleat
23" x 23"



Urban Pot planters are made of sturdy, lightweight polyethylene. Designed to be maintenance free, these planters can be left outdoors all year round, even in harsh winter climates. The double-walled design keeps soil cool and protects roots when exposed to hours of intense sunlight, as well as when temperatures drop.

- 10 year limited warranty
- Double wall for root protection
- Light and robust
- Food safety
- 100% recyclable
- Both 30" and 40" bowls include our 3-in-1 plug system. Use without a plug for drainage, a leak-proof plug for water gardening, or a drilled plug to thread a fountain wire through the bottom.
- No drainage hole for the 22" Orinoco bowl



Bleeker
Small: 13" diameter x 26" high



The Bleeker Large Resin Planter is the round version of the Bowery. This tall planter is robust and can be left outside all winter without any special maintenance. The planter is lined to protect the soil from direct sunlight and has a feature to add sand to the base to stabilize the planter as needed.

OUTDOOR PLANTERS



Homecrest Anthem Cushion

OUTDOOR SEATING OPTIONS

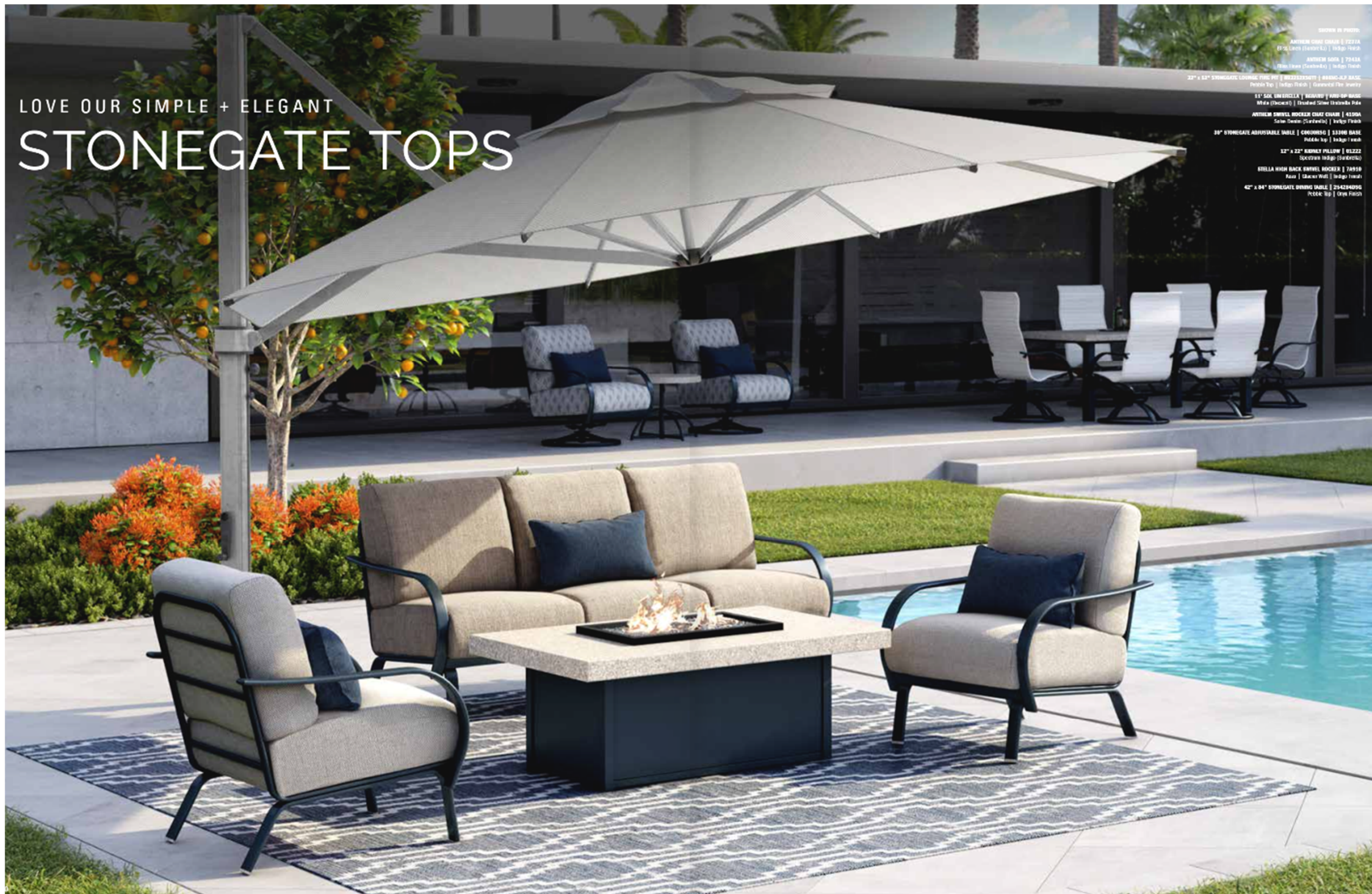

LOVE OUR SIMPLE + ELEGANT
STONEGATE TOPS

SHOWN IN PHOTO:
 PATIO: 10' x 10' | 10' x 10' | 10' x 10'
 10' x 10' | 10' x 10' | 10' x 10'
 10' x 10' | 10' x 10' | 10' x 10'
 10' x 10' | 10' x 10' | 10' x 10'
 10' x 10' | 10' x 10' | 10' x 10'
 10' x 10' | 10' x 10' | 10' x 10'
 10' x 10' | 10' x 10' | 10' x 10'
 10' x 10' | 10' x 10' | 10' x 10'
 10' x 10' | 10' x 10' | 10' x 10'
 10' x 10' | 10' x 10' | 10' x 10'

Homecrest

OUTDOOR SEATING OPTIONS



Bargmann Hendrie + Archetype, Inc | Cooper Center for Active Living, Newton, MA

WREN CUSHION

ALUMINUM

Our Wren collection is inspired by a bird in flight, the arms curving downward like wings gliding gracefully over water. The frame is constructed using powder-coated aluminum extrusions, ensuring maximum durability and weather resistance. Wren's size and scale is a representation of our long heritage of crafting quality furniture for every outdoor space. The comfortable cushions offer a seating experience as relaxing as it is functional.

Available in: C Cushion



CHAT CHAIR
C 0621A
 H: 32" W: 35" D: 30"
 Seat H: 18" Arm H: 24"



SWIVEL ROCKER CHAT CHAIR
C 0699A
 H: 32" W: 35" D: 30"
 Seat H: 18" Arm H: 24"



LOVESEAT
C 0642A
 H: 32" W: 56" D: 30"
 Seat H: 18" Arm H: 24"



SOFA
C 0643A
 H: 32" W: 79" D: 30"
 Seat H: 18" Arm H: 24"

▶ TAKE NOTICE

If a pattern is selected for the arms (i.e. a stripe), the pattern will be rotated 90 degrees from how it appears on the cushion.



SCAN + WATCH
 Learn more
 about the
 Wren cushion
 collection here!

SHOWN BY PHOTO:
 SWIVEL ROCKER CHAT CHAIR | 0699A
 LOVESEAT | 0642A
 SOFA | 0643A
 32" x 56" LATITUDE LOUNGE FIRE PIT | 880204LTT | 3400C 1/3 BASE
 CUSHION | 0621A
 18" SQUEL PILLLOW | 0601A
 12" x 22" KIDNEY PILLLOW | 013322
 * see details | www.bh.com

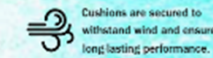

Cushions are secured to withstand wind and ensure long lasting performance.

Homecrest

OUTDOOR SEATING OPTIONS



Bargmann Hendrie + Archetype, Inc | Cooper Center for Active Living, Newton, MA



COURTESY OF ARIA IN EDINA, MN

FEATURED COLLECTIONS



ELEMENTS CHAT CHAIR
AIR | ALUMINUM

The Elements air collection features the appearance and comfort of deep seating in a foam-free, cushionless construction. Luxurious Sensation sling fabric is used for the ultimate in low-maintenance comfort and also features benefits such as exceptional shape retention and surface memory.

PRODUCT #: 51AR390
HEIGHT: 34" **WIDTH:** 32.5" **DEPTH:** 33"
SEAT HEIGHT: 14.5" **ARM HEIGHT:** 21"



ELEMENTS SOFA
AIR | ALUMINUM

The Elements air collection features the appearance and comfort of deep seating in a foam-free, cushionless construction. Luxurious Sensation sling fabric is used for the ultimate in low-maintenance comfort and also features benefits such as exceptional shape retention and surface memory.

PRODUCT #: 51AR430
HEIGHT: 34" **WIDTH:** 85" **DEPTH:** 33"
SEAT HEIGHT: 14.5" **ARM HEIGHT:** 21"



ALLURE ADJUSTABLE CHAISE
SLING | ALUMINUM

The clean lines of the Allure collection offer a minimalist visual style that will bring sophistication to any outdoor space. Its double layer sling design provides premium comfort, while a powder-coated aluminum frame offers strength and durability. Allure also has coordinating cushion and mesh pieces.

PRODUCT #: 11310
HEIGHT: 35" **WIDTH:** 28" **LENGTH:** 77"
SEAT HEIGHT: 16" **ARM HEIGHT:** N/A

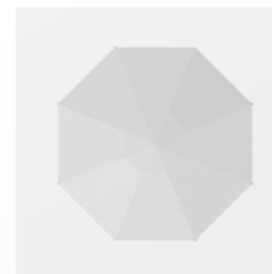

MARKET UMBRELLA
9' PULLEY LIFT

The dining/café height market umbrella features a 9' octagonal canopy—which is available in several fabrics—and a durable pulley lift mechanism. It also comes with a matte bronze, matte silver, or matte black pole option.

PRODUCT #: 854FM
DIAMETER OF OPENED CANOPY: 108"
FLOOR TO TOP OF UMBRELLA: 97"
FLOOR TO BOTTOM OF CLOSED CANOPY: 41"
FLOOR TO BOTTOM OF OPEN CANOPY: 77"



Homecrest Latitude (Aluminum)
54" Dining Table



Stackable Armless Café Chair
HEIGHT: 32.5"WIDTH: 20"DEPTH: 21"
SEAT HEIGHT: 18"



Stackable Café Chair
HEIGHT: 32.5"WIDTH: 20"DEPTH: 21"
SEAT HEIGHT: 18"

OUTDOOR TABLE AND CHAIR OPTIONS

HOMECREST UMBRELLAS

MARKET + CANTILEVER + GIANT PULLEY LIFT

Add the final touch to your outdoor space with Homecrest Outdoor Living's stylish and durable umbrellas. Whether you are designing for your home or business, we have you covered with our market, cantilever, and giant pulley lift options. All of our umbrellas are built with commercial-grade materials, so you can enjoy worry-free shade for years to come. Plus, you can choose from our full selection of fabric offerings to tailor your umbrella to suit your personal aesthetic or project specifications.



MARKET UMBRELLA CRANK LIFT/AUTO TILT

This is the ONLY crank lift/auto tilt in the industry designed and warranted for commercial use. Our crank lift/auto tilt market umbrella is engineered to withstand 40 mph sustained winds.

- 316 stainless steel, commercial-grade, 60° tilt crank handle and axle
- 1.5" diameter center pole with a durable 1/8" aluminum wall thickness provides incredible strength and durability
- 1/2" fiberglass ribs and struts for maximum strength and flexibility
- Stainless steel grommets attach the canopy securely to the frame
- 4-layer fabric protection and closed stitching pocket



6.5' SQUARE	7.5' OCTAGON	9' OCTAGON
454FMA SQ - 20 lbs	645FMA - 20 lbs	854FMA - 22 lbs
A - Overall Height: 107"	A - Overall Height: 98"	A - Overall Height: 107"
B - Clearance: 79"	B - Clearance: 72"	B - Clearance: 79"
C - Closed Clearance: 41"	C - Closed Clearance: 49"	C - Closed Clearance: 48"
D - Crank Clearance: 36"	D - Crank Clearance: 36"	D - Crank Clearance: 36"
Max Diameter: 1.5"	Max Diameter: 1.5"	Max Diameter: 1.5"

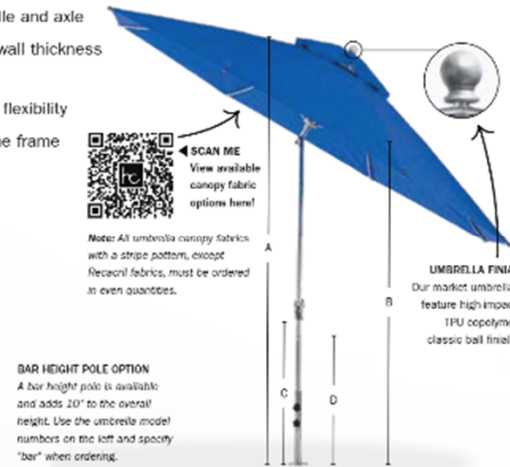

BAR HEIGHT POLE OPTION
A bar height pole is available and adds 10" to the overall height. Use the umbrella model numbers on the left and specify "bar" when ordering.



MARKET UMBRELLA PULLEY LIFT

Our easy glide pulley system is supported by a durable woven cord that allows you to effortlessly open and close the umbrella. All of our pulley lift umbrellas are designed with a hook pin to keep the pulley cord out of reach and out of sight. Our pulley lift market umbrella is engineered to withstand 40 mph sustained winds.

- 1.5" diameter center pole with a durable 1/8" aluminum wall thickness provides incredible strength and durability
- 1/2" fiberglass ribs and struts for maximum strength and flexibility
- Smooth and effortless pulley system
- Stainless steel grommets attach the canopy securely to the frame
- 4-layer fabric protection and closed stitching pocket



6.5' SQUARE	7.5' OCTAGON	9' OCTAGON
454FMA SQ - 16 lbs	645FM - 16 lbs	854FM - 18 lbs
A - Overall Height: 97"	A - Overall Height: 94"	A - Overall Height: 97"
B - Clearance: 77"	B - Clearance: 76"	B - Clearance: 77"
C - Closed Clearance: 41"	C - Closed Clearance: 44"	C - Closed Clearance: 41"
Max Diameter: 1.5"	Max Diameter: 1.5"	Max Diameter: 1.5"

BAR HEIGHT POLE OPTION
A bar height pole is available and adds 10" to the overall height. Use the umbrella model numbers on the left and specify "bar" when ordering.

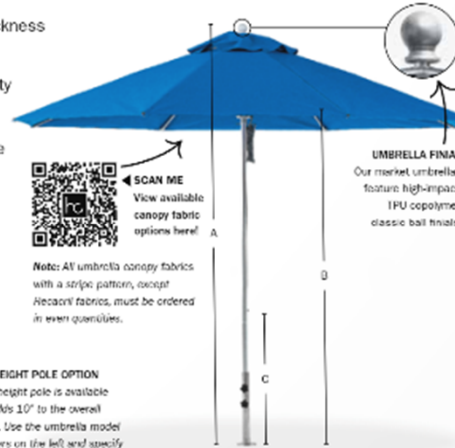

AVAILABLE BASE OPTIONS Note: Umbrella bases are available in all Homecrest frame finishes, except for the premium aluminum base, which is silver mist.



CAST IRON	ALUMINUM SHELL	PREMIUM ALUMINUM BASE (with Wheels)
00091 - 45 lbs	00092 - 30 lbs	100A - 100 lbs
H: 20.5" W: 20" D: 20"	H: 6.5" W: 15.5" D: 15.5"	H: 4" W: 24" D: 24"
	Must fill with sand.	

Note: Umbrella clearance dimensions are measured while not mounted in a base. Depending on the selected base, these clearance measurements will change. All dimensions have a 1/8" tolerance based on the pitch angle of the umbrella rib. This is due to multiple variables: pin placement height, crank thickness, and fabric weight.

AVAILABLE POLE COLORS

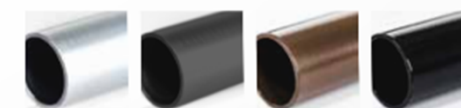

BRUSHED SILVER	CARBON	DESERT BRONZE	ONYX
	Note: This is not an exact match to our Carbon paint finish.		Note: This is not an exact match to our Onyx paint finish.

Available in: Umbrella

OUTDOOR SEATING OPTIONS – UMBRELLA



West Elm
Concrete Indoor/Outdoor Pedestal Round
Dining Table (32", 44", 60")



60" shown in white



Allsteel –
Gunlocke
Briefing Storage
48” x 24” x 27 1/2”
case
48” x 24” x 1 3/16”
top



Gunlocke standard height metal
ribbon base GD2HBS84-A
42/48 x 84 32 1/8 58 27 1/2
GD2HBS84-A \$10,867



Gunlocke standard height metal
base
GG2YBS84-A + optional beam
36/42/48 x 84 33 3/8 72 1/8 27 3/4
GG2YBS84-A \$2,411



Gunlocke Briefing 48” arc boat top GD2TAB4884
48”w center 46 1/2”w end 84”l
\$4,592 wood veneer 1 \$5,052 wood veneer 2 \$3,678 laminate
Standard height Miter Base wood GD2MBS84-AW
42/48 x 84 24 3/4 47 3/4 27 5/8 GD2MBS84-A \$6,258 wood veneer 1 \$6,884 wood veneer 2



CONFERENCE TABLE OPTIONS



Marketplace

Heavy Duty Conference Table, Reclaimed Wood And Steel

/ Ships in 6 weeks

This listing shows an example of our heavy duty conference table base using 3" square steel tube. Designed to span large distances eliminating the needs for additions legs and supports in the middle. The table shown spans 10" with 15" overhangs on each end for a 13'-6" long table. This can be designed for just about any length and width. The top shown is reclaimed Douglas fir factory flooring. Hardwoods are also available.

CONFERENCE TABLE OPTIONS



West Elm
Sterling 5-Star Armless Conference
Chair

Overall:
23.5"w x 24.5"d x 30"h
Seat height:
15"-21.5"h
Seat depth:
18.6"
Seat width:
22"
Product weight:
33 lbs.
Weight capacity:
275 lbs.

Upholstery grade bent plywood frame.
Molded polyurethane foam cushioning.
5-star aluminum legs.
Adjustable seat height.
360 degree swivel.
Your choice of hard or soft protective leg casters.
Hard protective casters for carpeted floors, soft protective casters for hard floors.
Covered by Steelcase® Limited Warranty and 30-day return policy.

CONFERENCE CHAIR OPTIONS



Allsteel Evo Conference



CONFERENCE CHAIR OPTIONS



Allsteel Retreat Executive Conference

CONFERENCE CHAIR OPTIONS