

Cooper Center for Active Living

Interior Finishes Presentation

August 15, 2024



LVT-2 Shaw Solitude 48559 French Gray

LVT-1 Shaw Solitude 48250 Natural

C-3 Shaw Contract Chok Loom 5A211
Pidan 99314

W-4 Anthology Woods Left Coast White Oak
Wood Accent walls

P-1

P-2

W-4

SS-1 Silestone Et Statuario

FP-1 Guilford of Maine FR-701
Verte Papier 561

C-5 Mannington Commercial Inertia
Kinetic 11360 - Lobby Walk-Off Mat

C-6 Bentley Mills Burnish 4BRT8
Modjeska Canyon 402920

LOBBY



Used at :
Admin Areas
and Offices

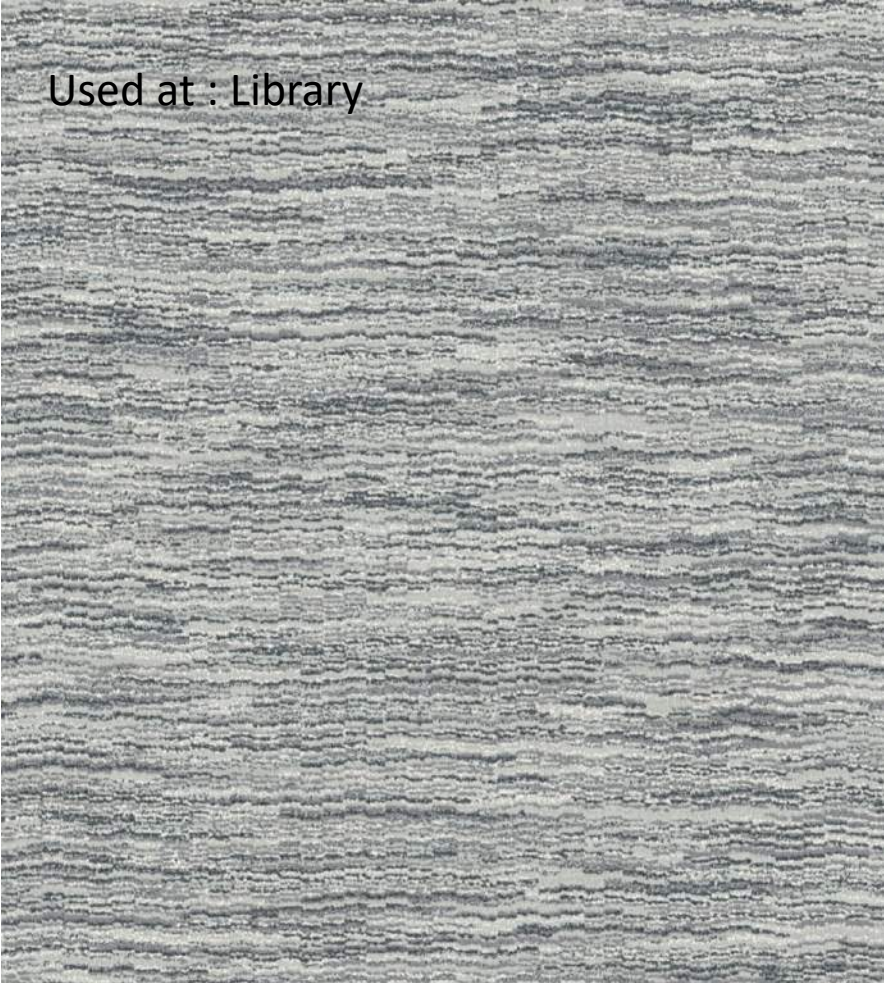

Used at : Library

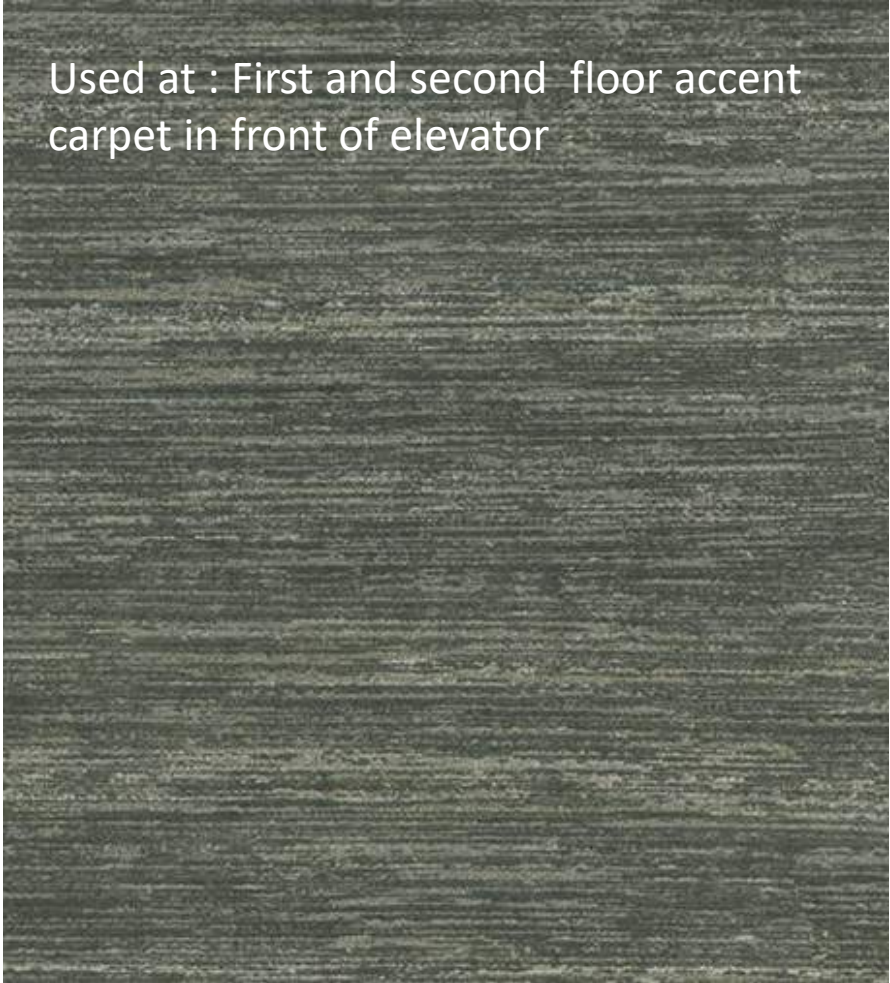

Used at : First and second floor accent
carpet in front of elevator

C-2 Shaw Contract Shale 5A357
Mineral

C-1 Mohawk Group
Social Canvas/Creative Culture GT483

C-3 Shaw Chok Loom 5A211
Pidan 99314

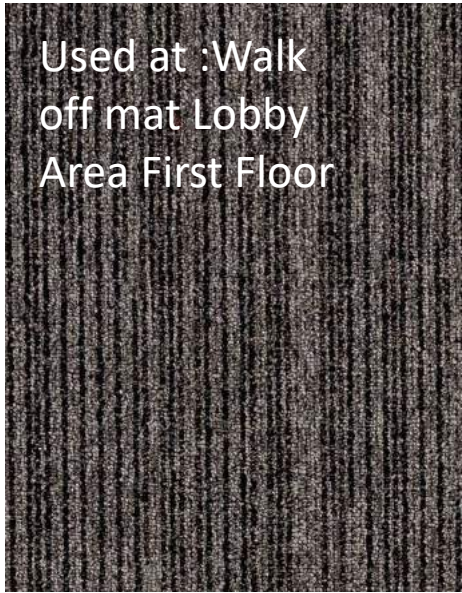

Used at :Walk
off mat Lobby
Area First Floor

C-5 Mannington Commercial Inertia
Kinetic 11360
Lobby Walk-Off Mat



Used at :Walk
off mat Entry
Vestibule

RM-1 Mats Inc Supreme Nop
Black Walnut Walk-Off Mat



Used at : Third floor accent carpet in
front of elevator

C-4 Shaw Contract Chok Loom 5A211
Pagoda 99515

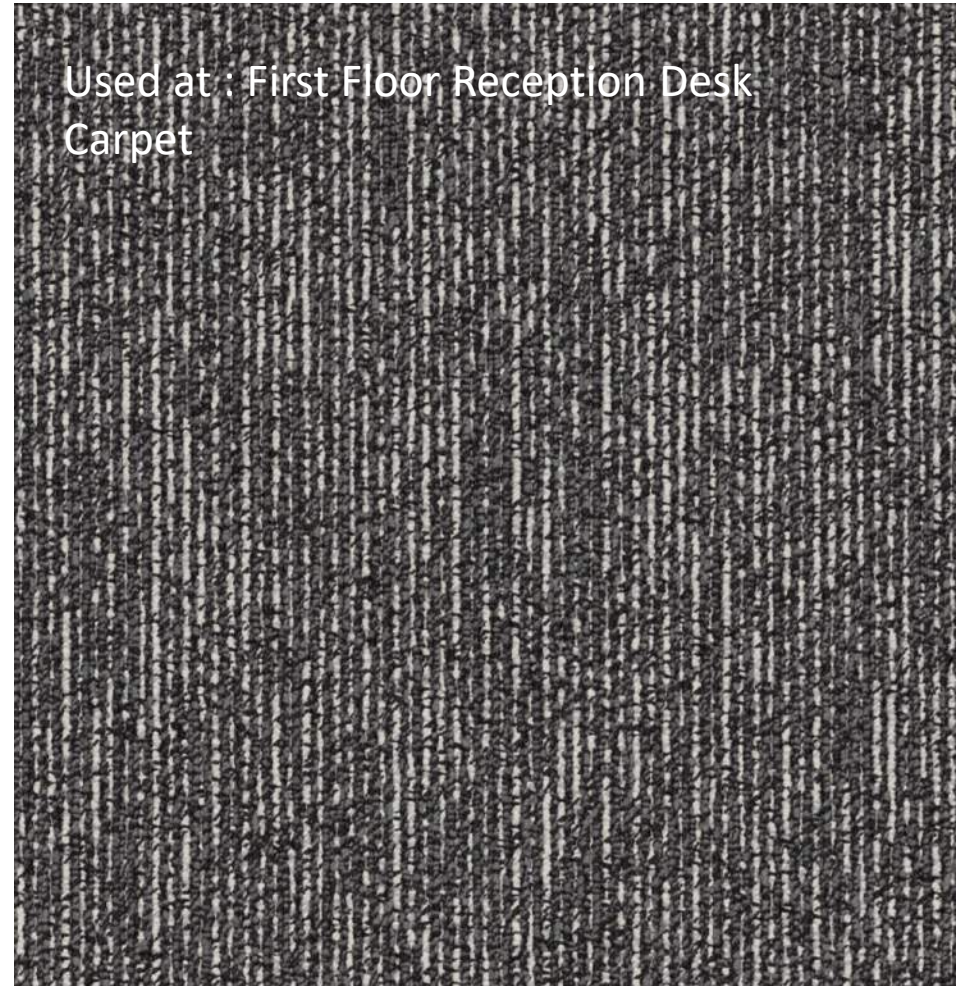

Used at : First Floor Reception Desk
Carpet

C-6 Bentley Mills Burnish 4BRT8
Modjeska Canyon 402920

Used at :Decorative stair runner

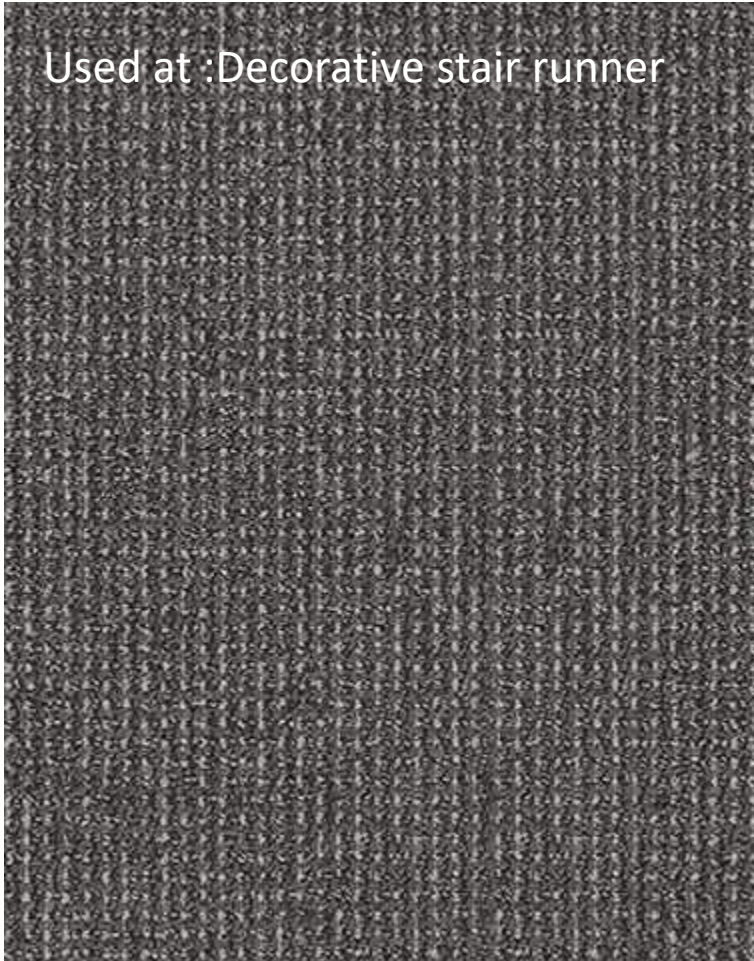

C-11 Shaw Contract Stay 5A247
Sense 47535 (option to be selected)
Stair Runner



Used at :Decorative stair runner
(Alternative option)



C-11 Shaw Contract Stay 5A247
Solace 47485 (option to be selected)
Stair Runner

Used at : Admin Copy room,
built in storage shelf, upper
cabinets @ staff kitchen, activity
rooms

PL-1 Wilsonart Solicor Linen D427-60
Matte

Used at : Lounge Juice Bar
cabinet and millwork, Multiple
Purpose room Millwork

PL-2 Wilsonart Ocala Walnut 8256K-05
Timbergrain Finish

Used at : Art Room Millwork

PL-3 Wilsonart Traceless Silver Velvet 15503
Ultra Matte

Used at : all Countertop surfaces (Juice Bar, Staff kitchen, Multiple purpose room, etc.)

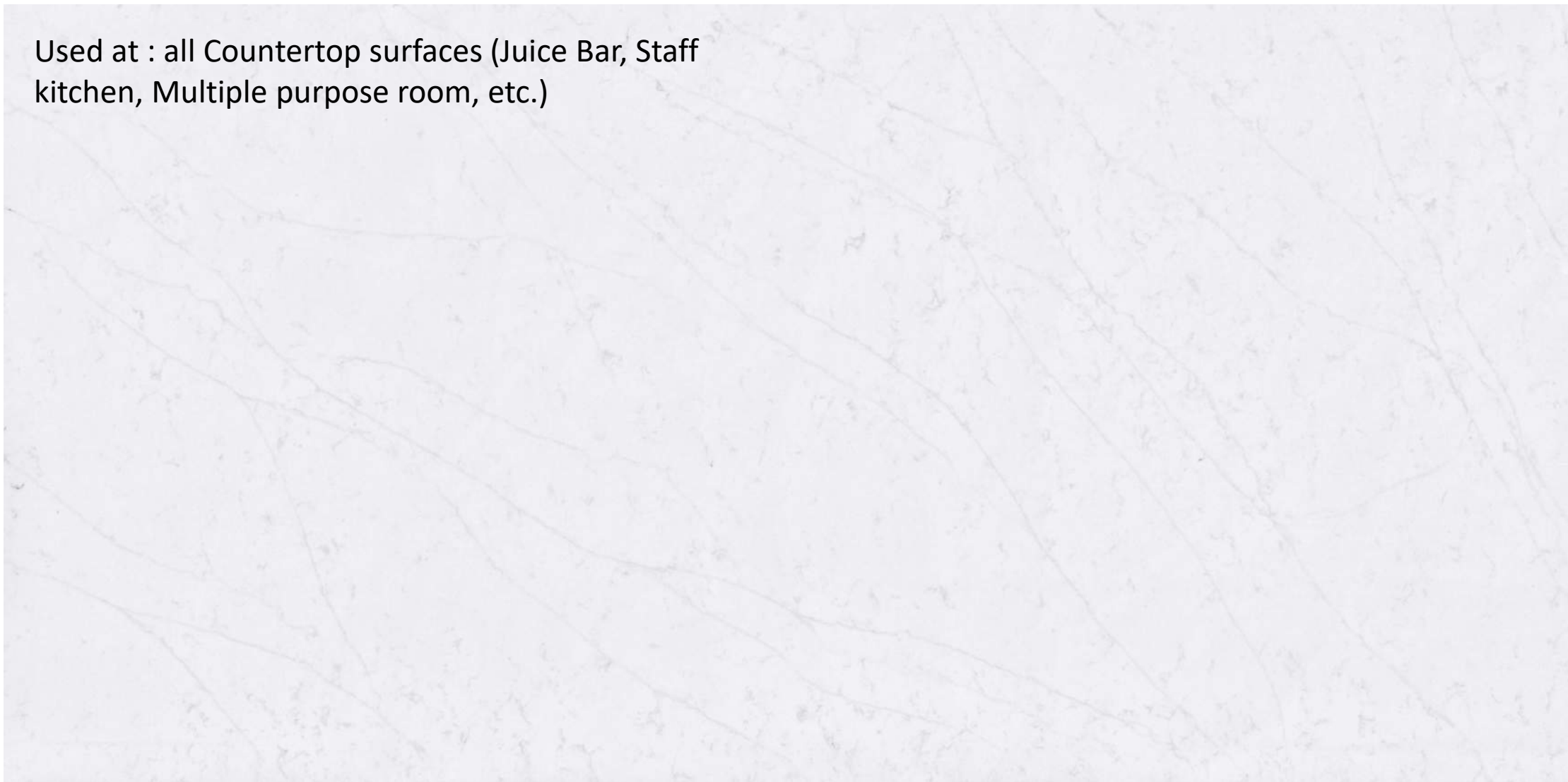

SS-1 Silestone Et Statuario

SOLID SURFACE

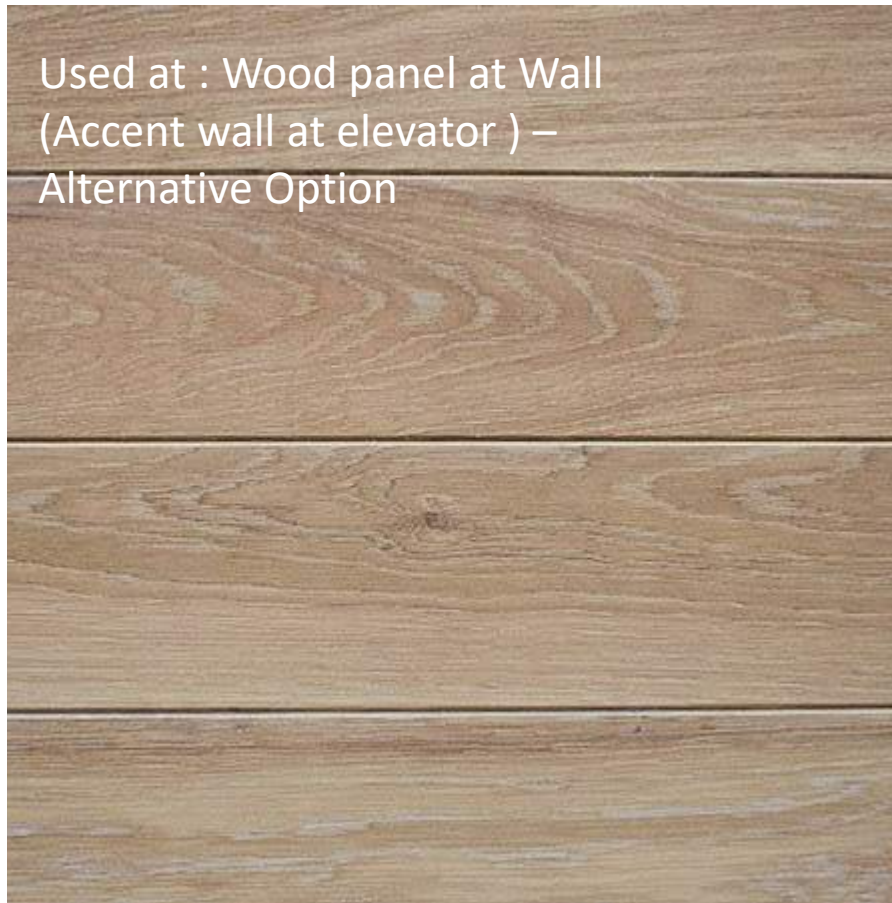

Used at : Wood panel at Wall
(Accent wall at elevator) –
Alternative Option

WD-4 (suggested option) Anthology Woods Legacy White
Oak, Natural Oil – White Oil
3/8" thickness



Used at : Wood panel at Wall
(Accent wall at elevator)

WD-4 (specified) Anthology Woods Left Coast White Oak,
Natural Oil
3/8" thickness

WOOD PANEL

Used at : All Wood Doors

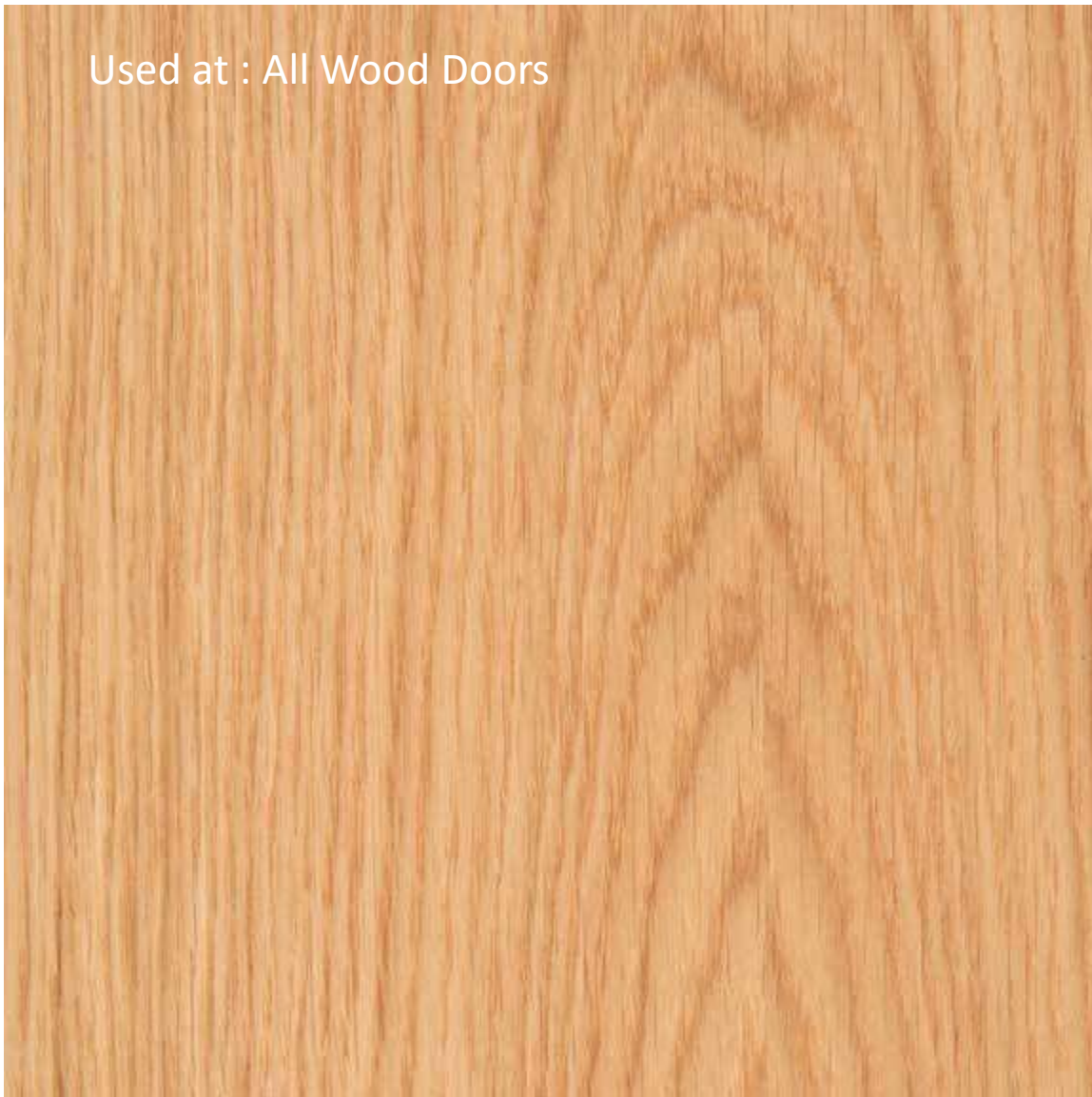

VT Architectural Wood Doors
Species: White Oak
Color Clear, CL18

WOOD DOORS

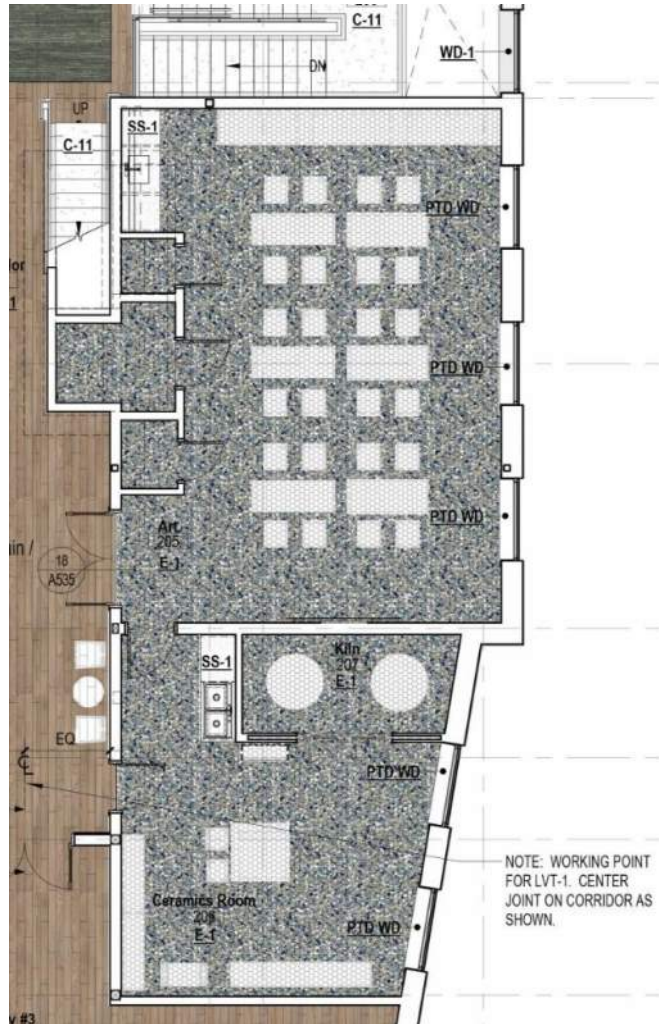

Used at : Art and Ceramic Room flooring



Ocean, Proposed Color

E-1 DUR-A-FLEX Epoxy Dur-a-chip floor system with Micro Chips

EPOXY FLOOR



Used at : Walking Track at Gym;
The divider strip is painted over
this surface

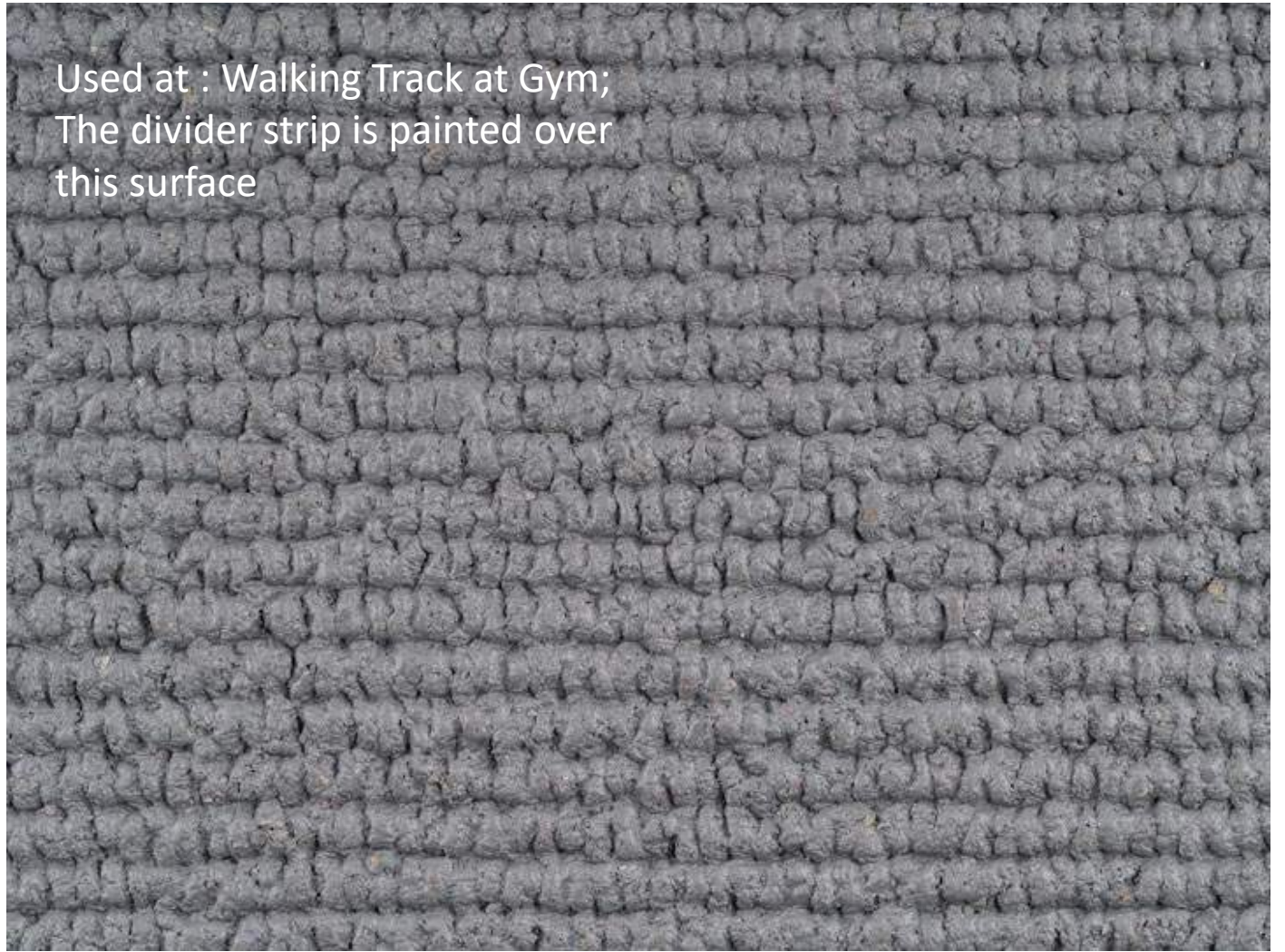

RF-1 Mondo Sportflex Super X Performance 720
P31
Walking Track

RESILIENT ATHLETIC FLOORING

Used at : Accent



LVT-2 Shaw Solitude 48559 French Gray

Used at : main LVT flooring



LVT-1 Shaw Solitude 48250 Natural



Used at : Egress Stairs

RF-2 Rubber Stair Tread and Riser
Tarkett Raised Round Grey 48

Used at :MDF Room

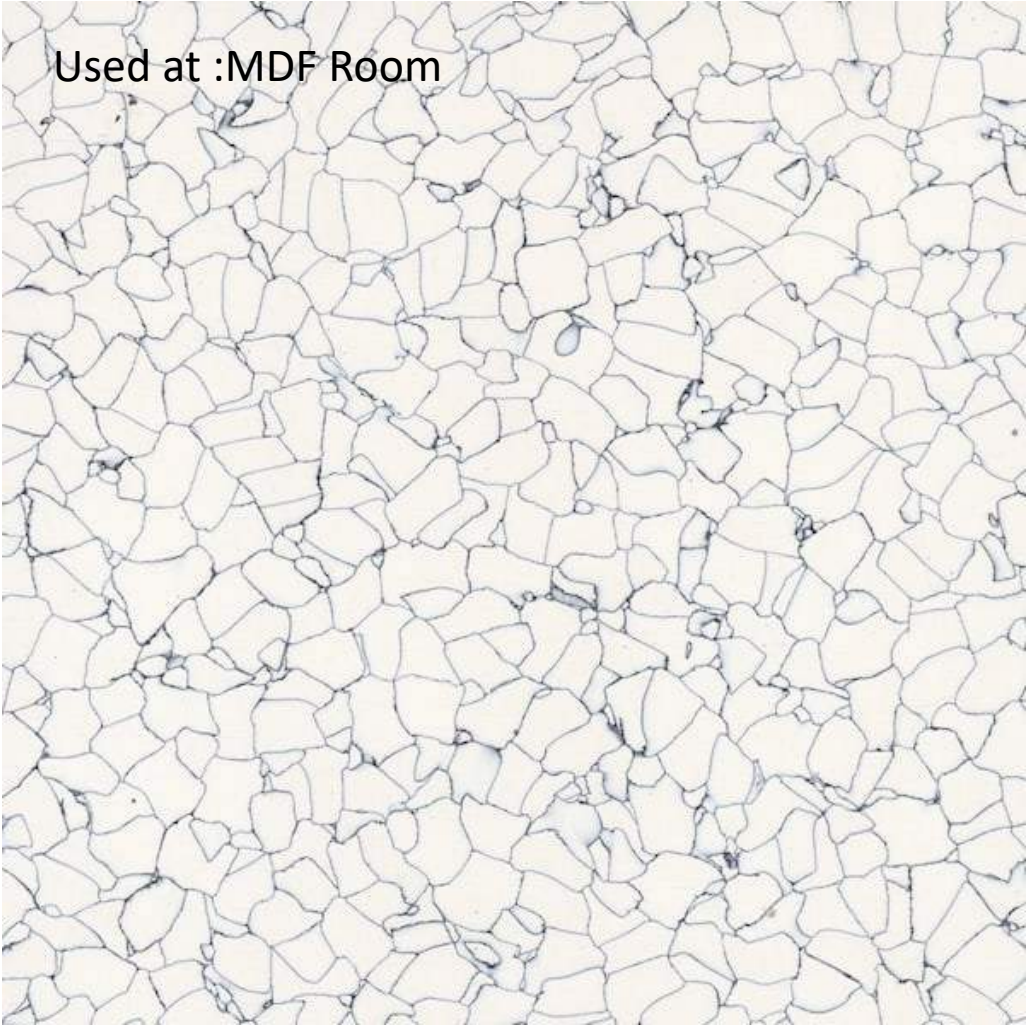

SDT-1 Staticworx Ameriworx /Classic ESD
Spring Snow

Used at :Closets and back of house areas

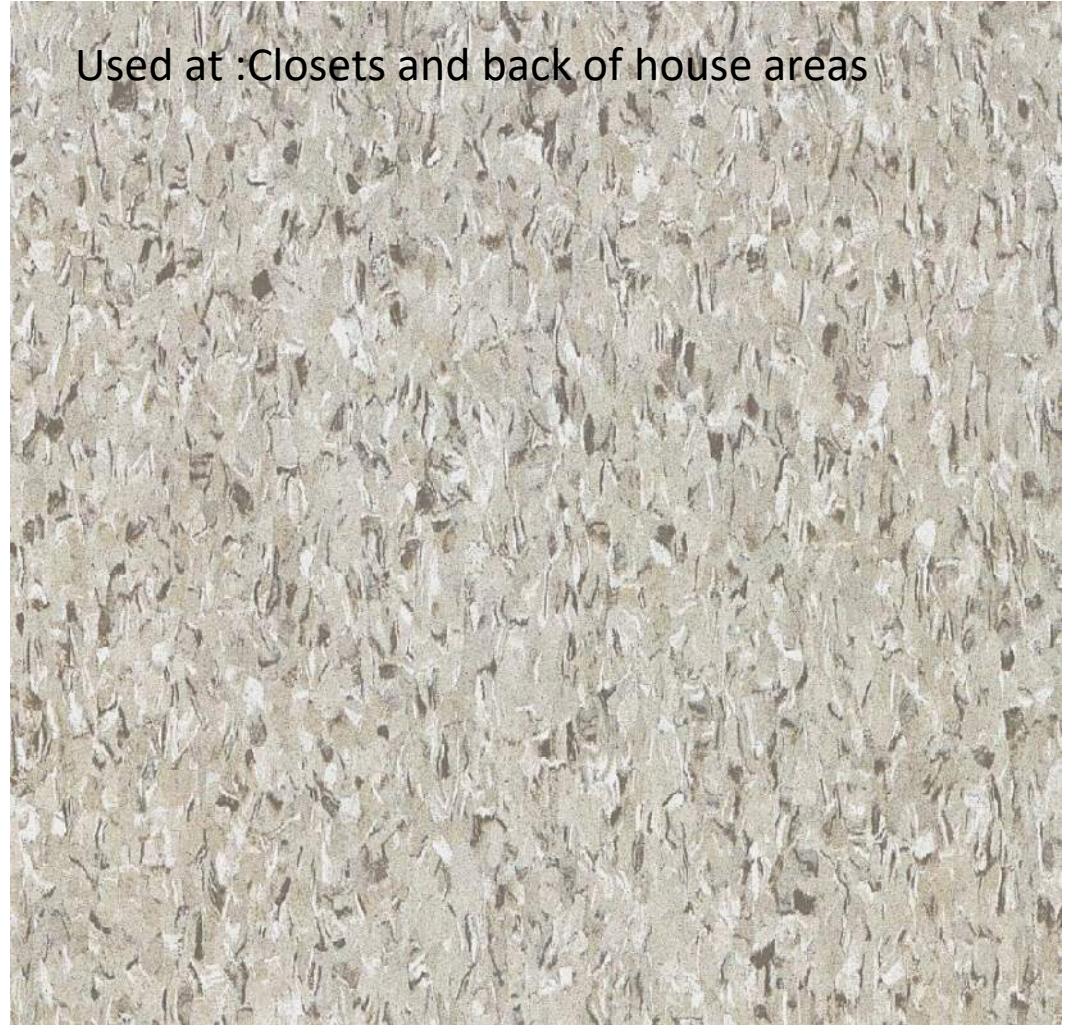

VCT-1 Armstrong Standard Excelon Imperial Texture
Pewter 51908

Used at : Wall Accents panel at reception desk
first floor (Alternative option)

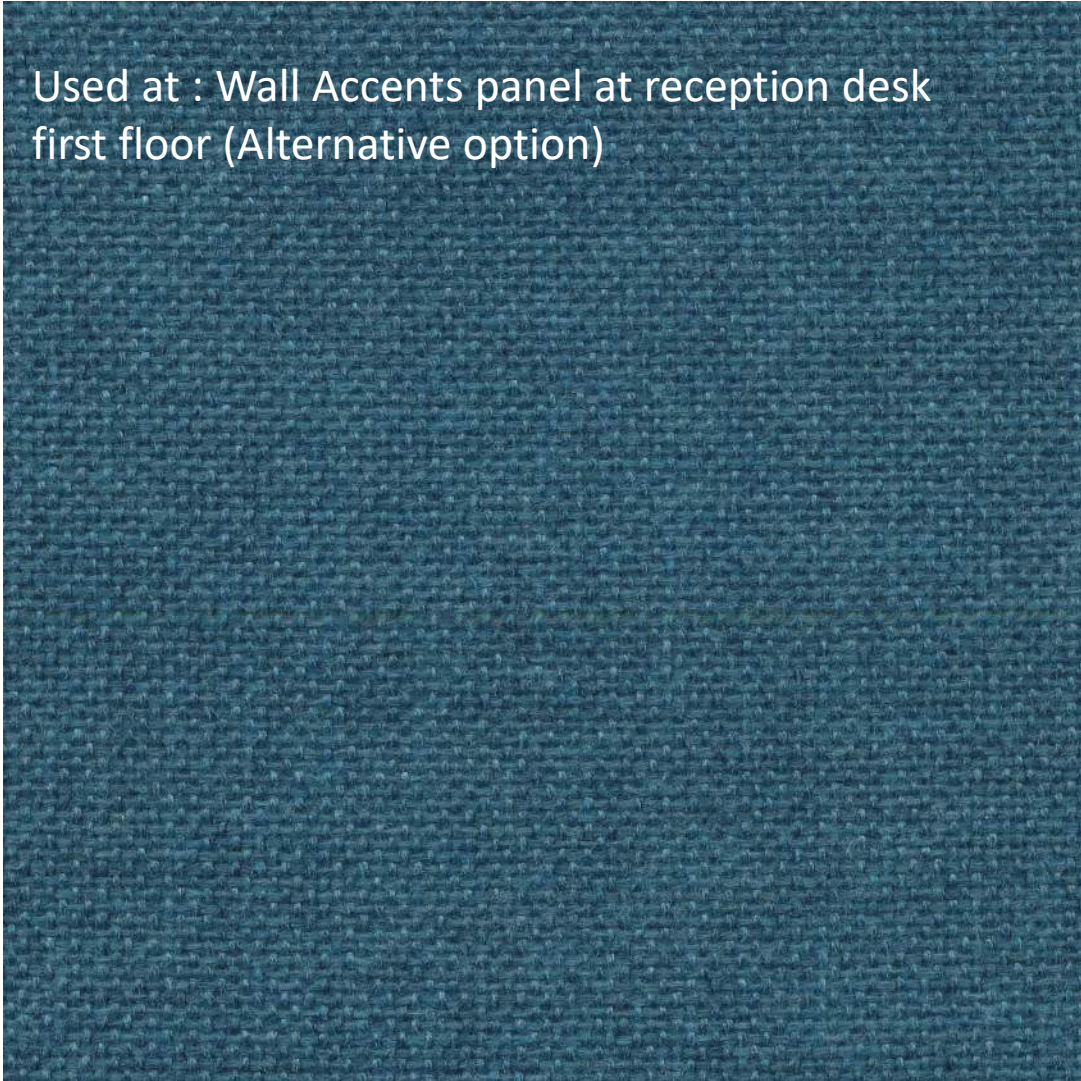

FP-1 Option Guilford of Maine FR-701
Ultramarine 470

Used at : Wall Accents panel at reception desk
first floor



FP-1 Option Guilford of Maine FR-701
Verte Papier 561

Used at : Multiple Purpose Room – Wall Panel
above Chair Rail

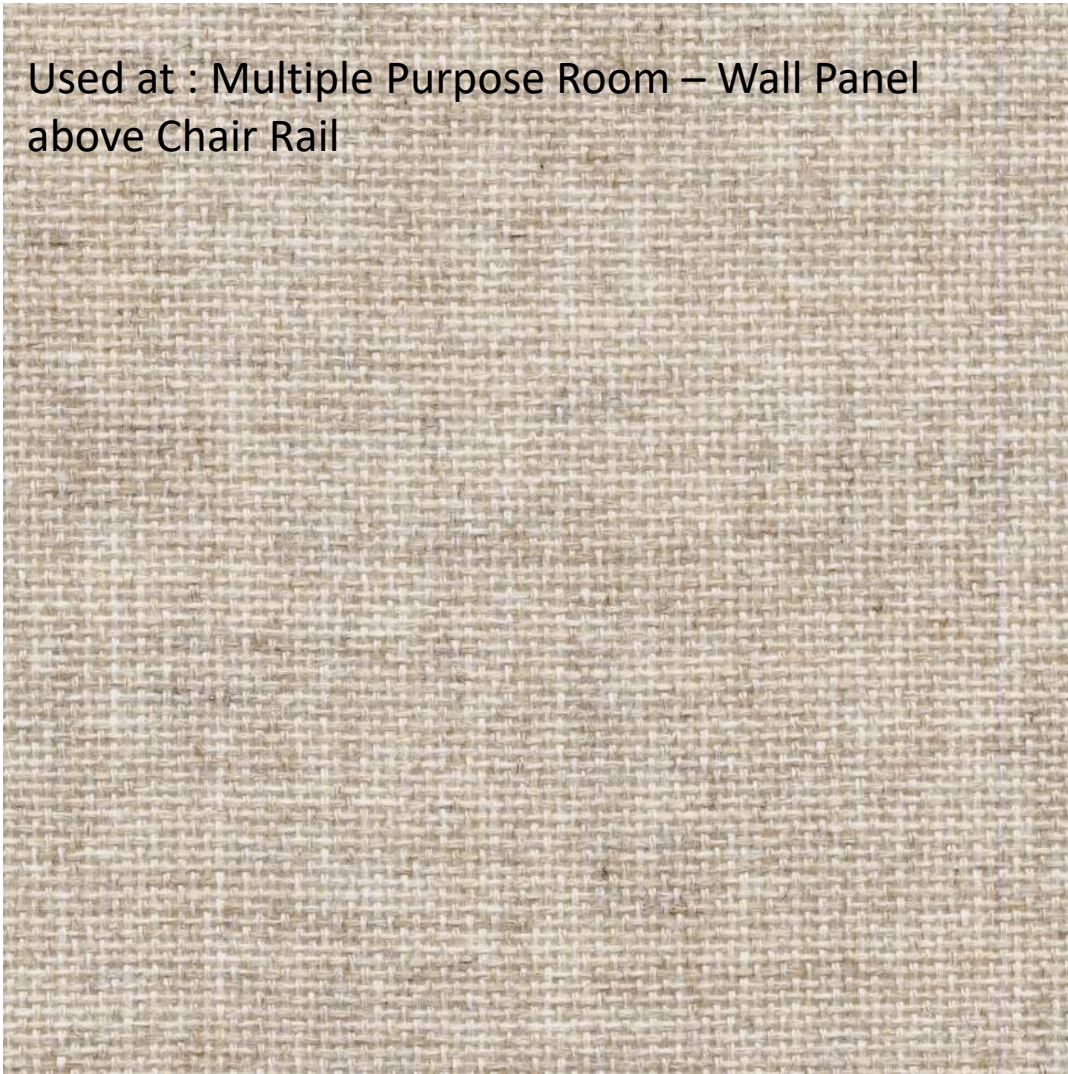

FP-2 Guilford of Maine FR-701
Quartz 380 (option)

Used at : Multiple Purpose Room – Wall Panel
above Chair Rail (Alternative Option)

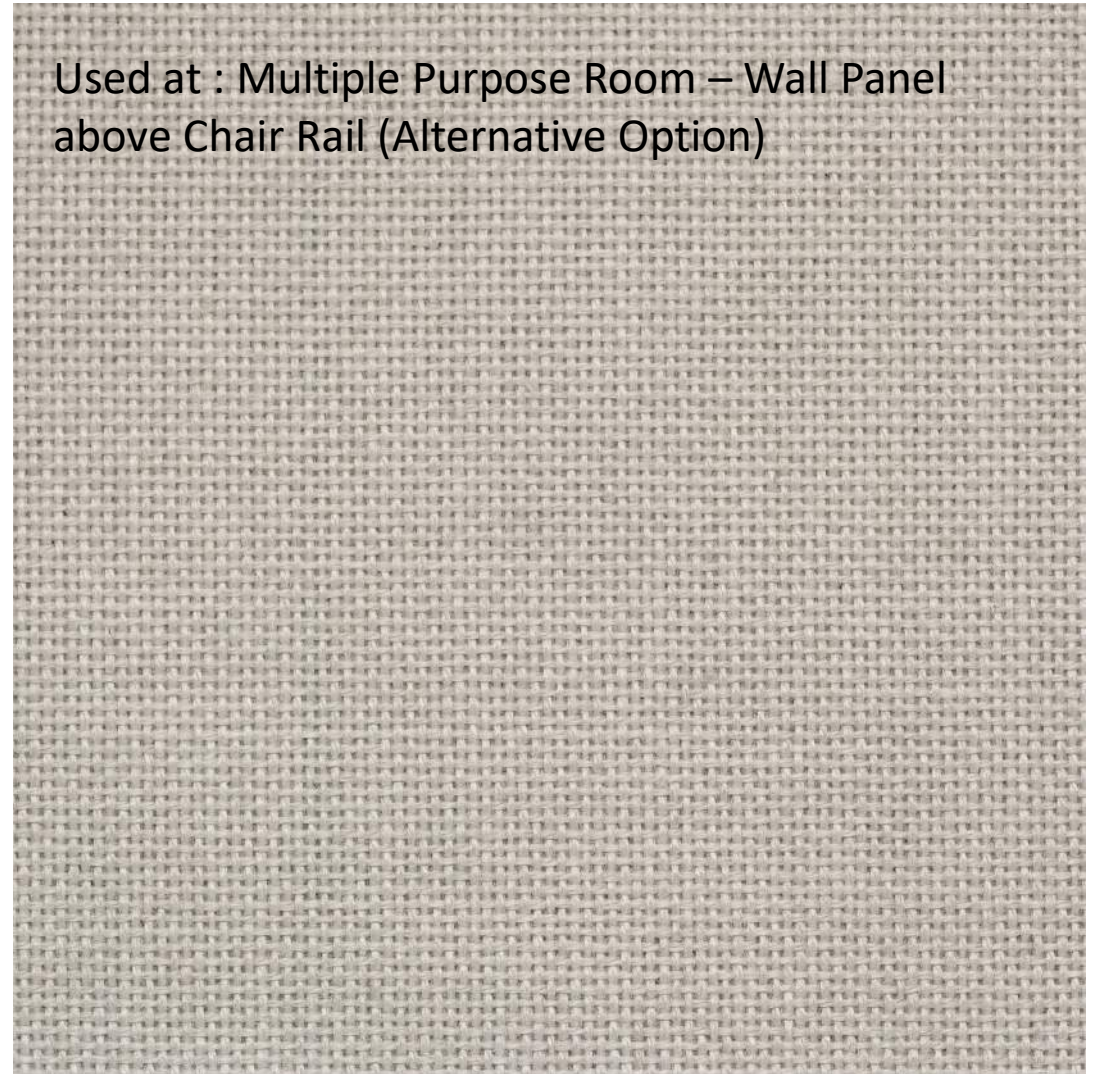

FP-2 Guilford of Maine FR-701
Pearl 481 (option)



Used at : Restroom
Flooring

CT-1 Crossville Owen Stone
OST04 Mittens
Ext/Textured 12" x 24"
With matching base 6" x 12"



Used at : Restroom
Wall tile (full height
@ wet wall only)

CT-1 Crossville Owen Stone
OST01 Down
Ext/Textured 12" x 24"



Used at : Commercial
Kitchen Flooring

QT-1 Daltile Quarry Tile Arid Flash
0Q48 Unpolished
6" x 6" with matching base 5" x 6"

floor / wall tiles



available sizes

TL18426	12"x24"x1/2" in stock
TL18397	8"x36"x1/2" *(S.O.)
TL18398	18"x36"x1/2" *(S.O.)
TL18400	24"x24"x1/2" in stock
TL18399	24"x48"x1/2" *(S.O.)
SL11410	slab 3/4" *(S.O.)
SL11411	slab 1 1/4" *(S.O.)

fusion gray polished marble

ST-1 Marble Systems, Inc. Fusion Gray Polished Wall Tile TL18426
12" x 24" x 1/2"
Library Fireplace Surround
(Availability to be confirmed)

STONE TILE

Used at : Lounge Juice Bar Counter
Backsplash



T-1 Nemo Industry Gesso / Matte
3" x 12" staggered
Lounge Counter Backsplash



ACT-1 Armstrong Optima White 48" x 48"

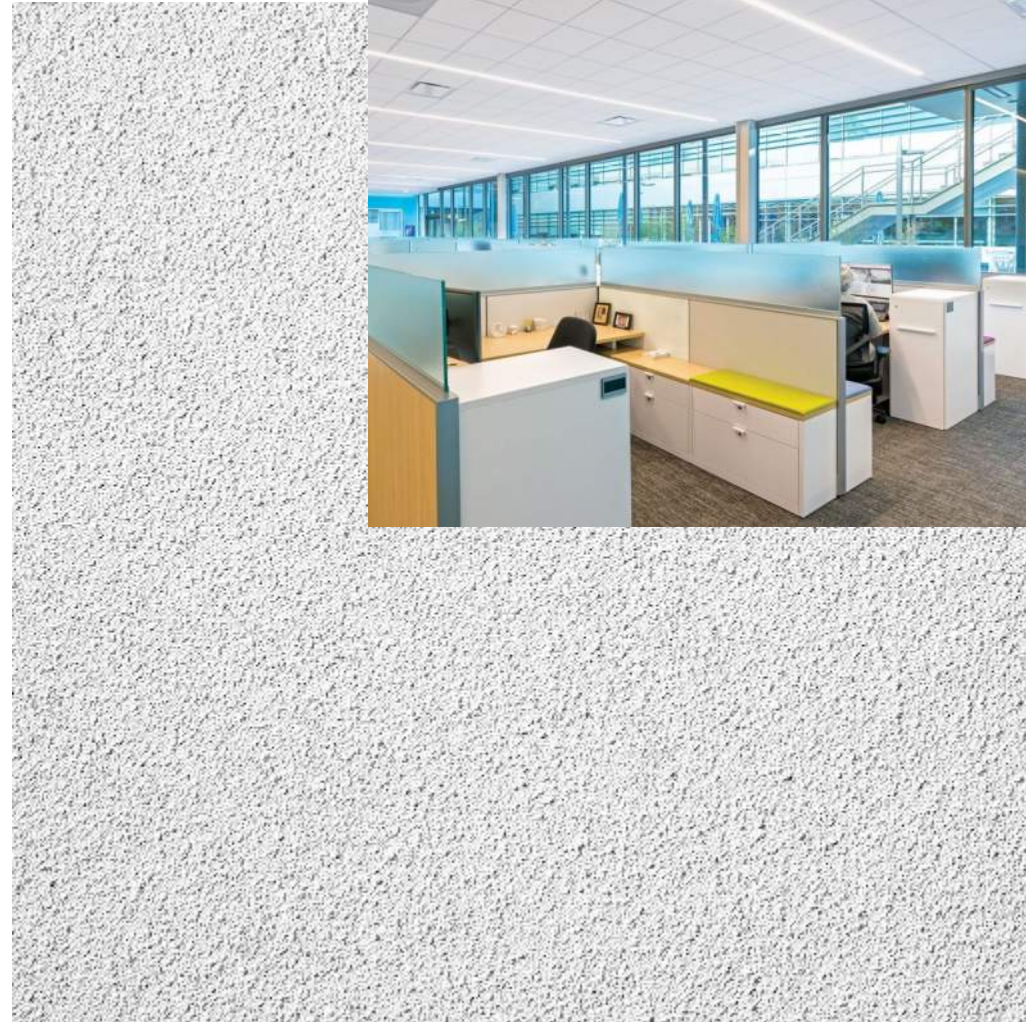

ACT-2 Armstrong Optima White 24" x 24"

ACOUSTIC CEILING TILE

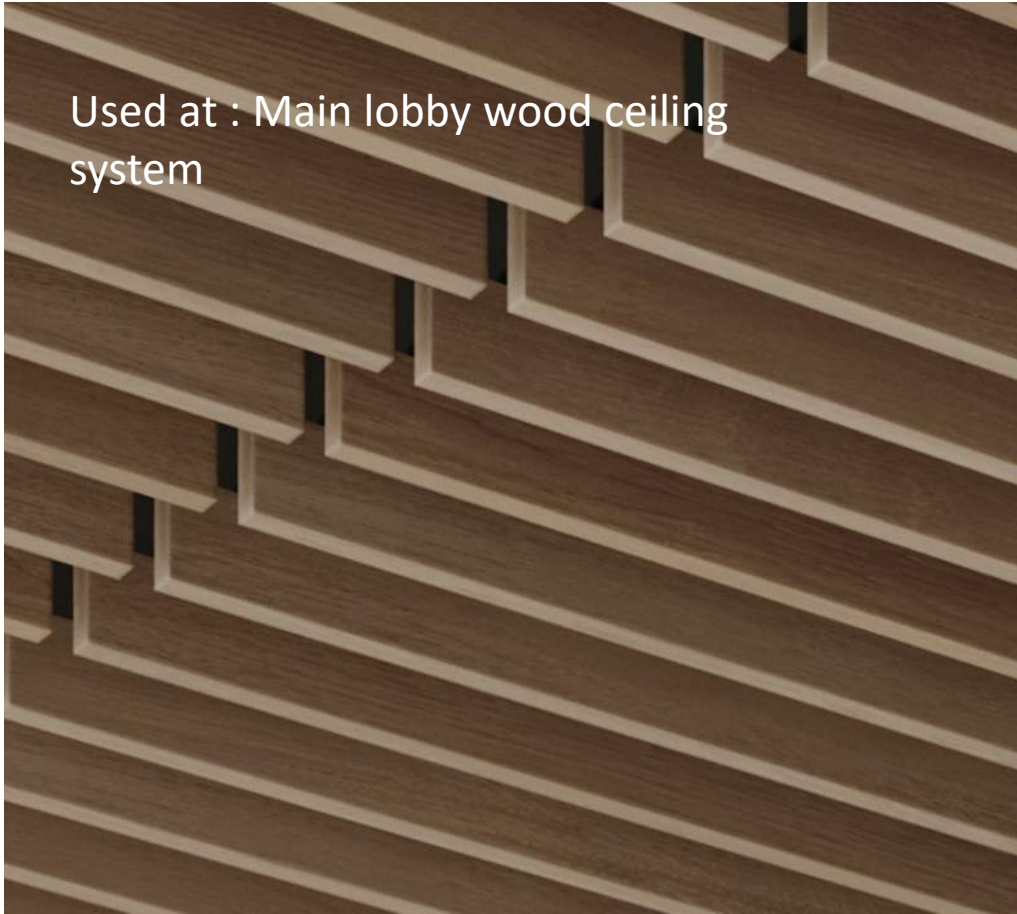

Used at : Main lobby wood ceiling system

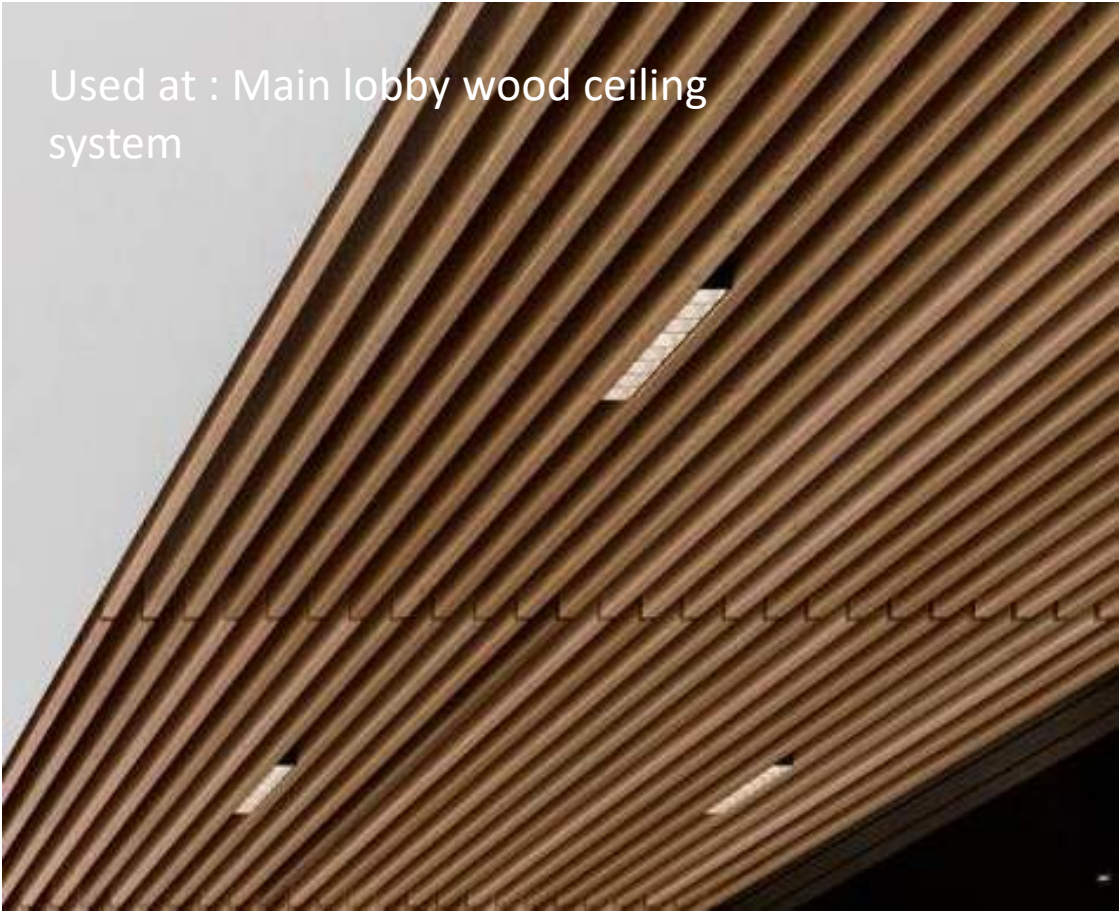

Used at : Main lobby wood ceiling system

Armstrong Woodworks Grille 4" x 96" x 3/4"
Red Oak on Poplar

WOOD CEILING

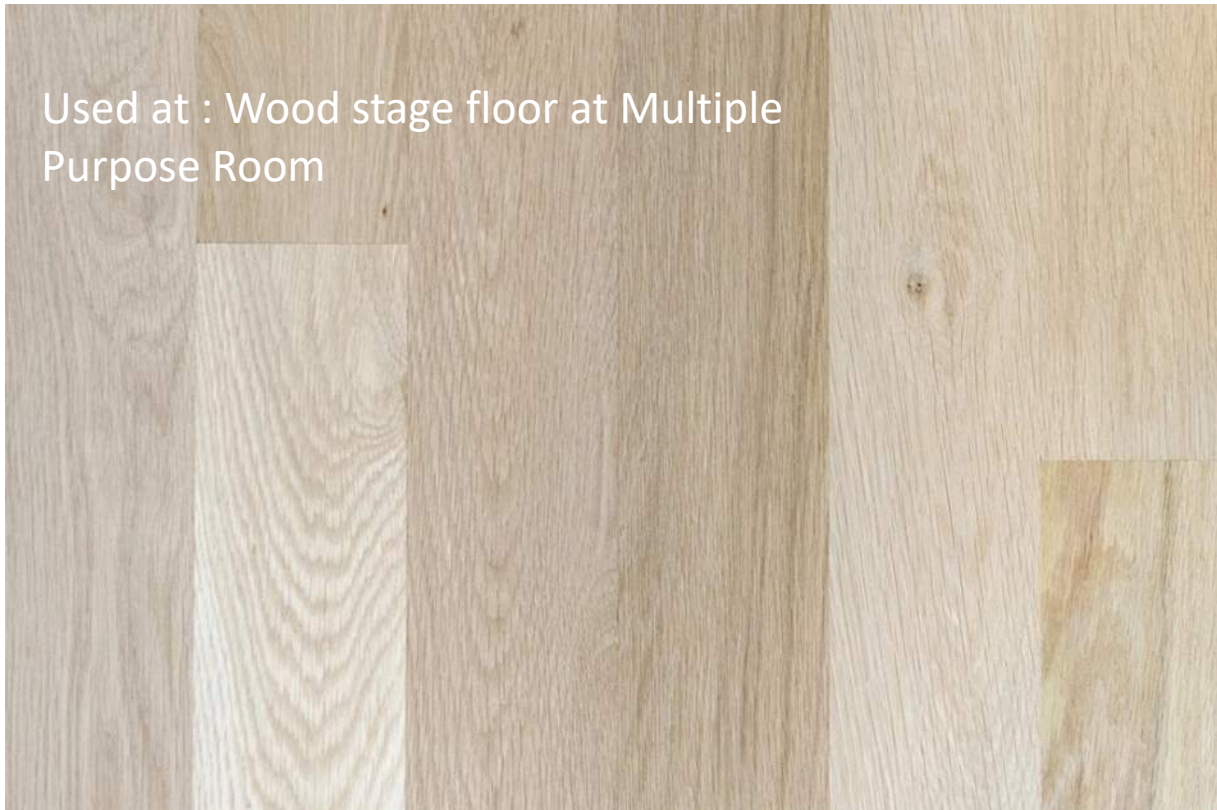

Used at : Wood stage floor at Multiple Purpose Room

WF-1 Pioneer Millworks White Oak Naked, Water Based Poly
6" width
Stage Floor



Used at : Wood stage floor at Multiple Purpose Room (Accent only) @ thread and riser

WD-3 White Oak Oil Stain to Match Control Sample
(Shown here is Walnut)
Stage Floor Perimeter, Tread and Riser

WOOD FLOORING

WF-2 Aacer Sports Flooring Aacercrush II Floating System
Northern Hard Maple

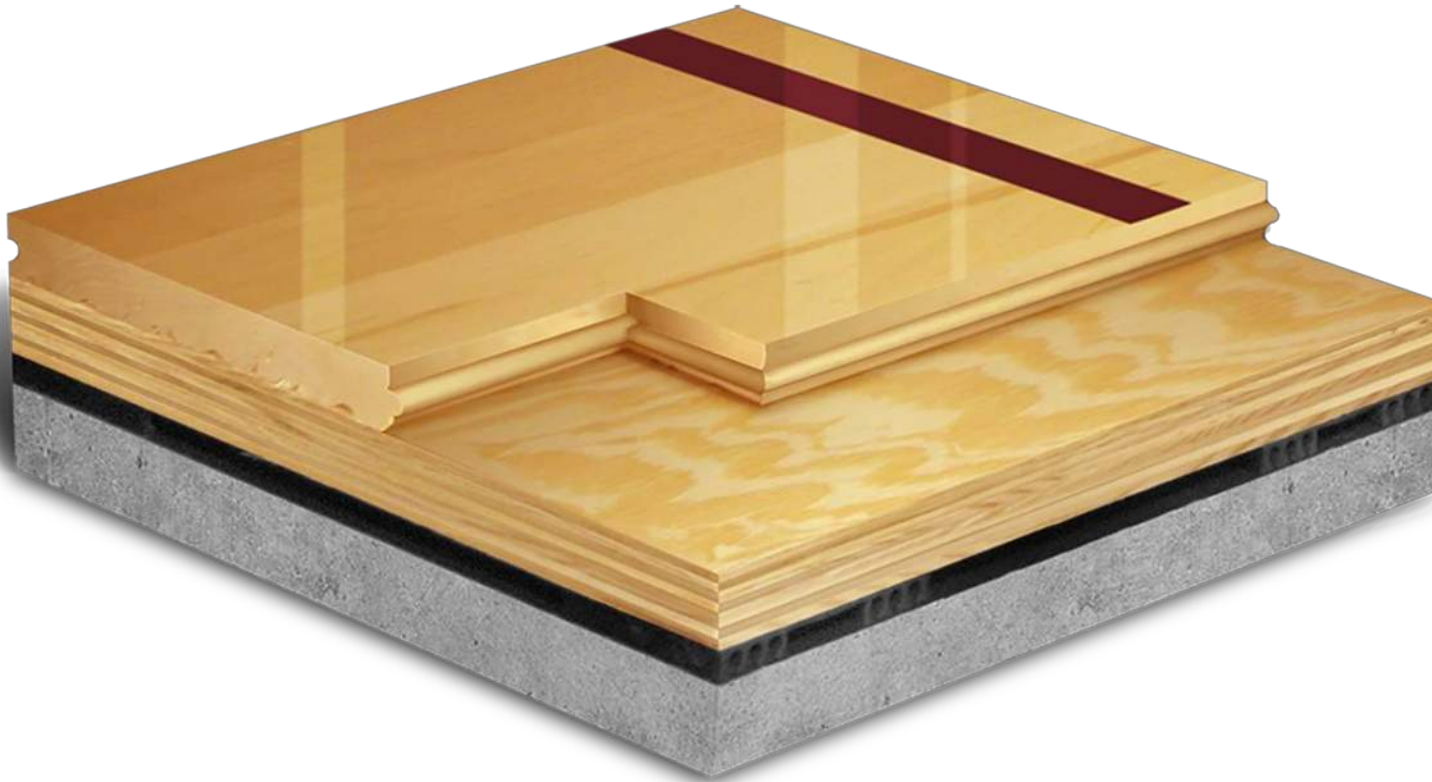

WOOD ATHLETIC FLOORING

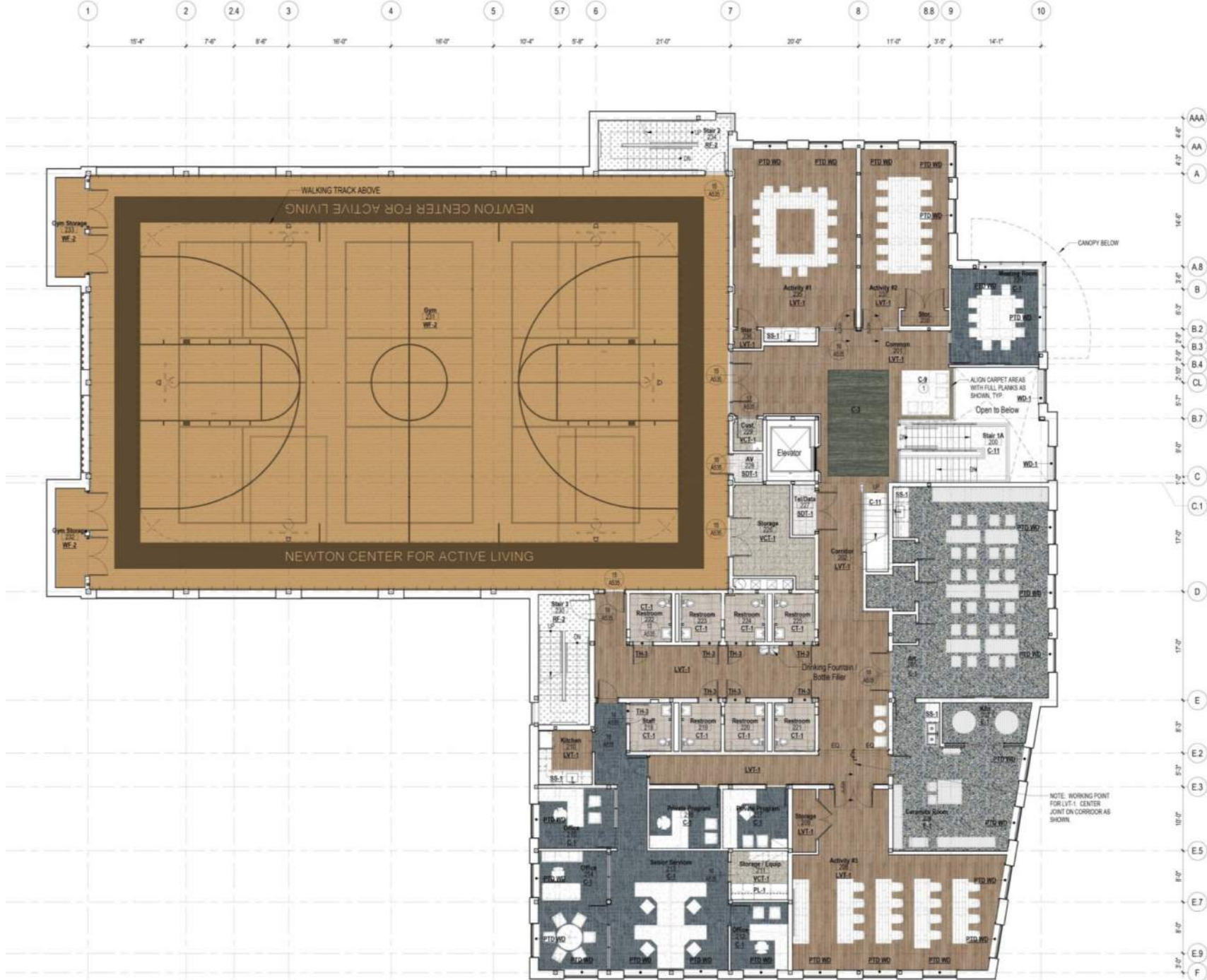

2nd FLOOR FLOOR FINISHES

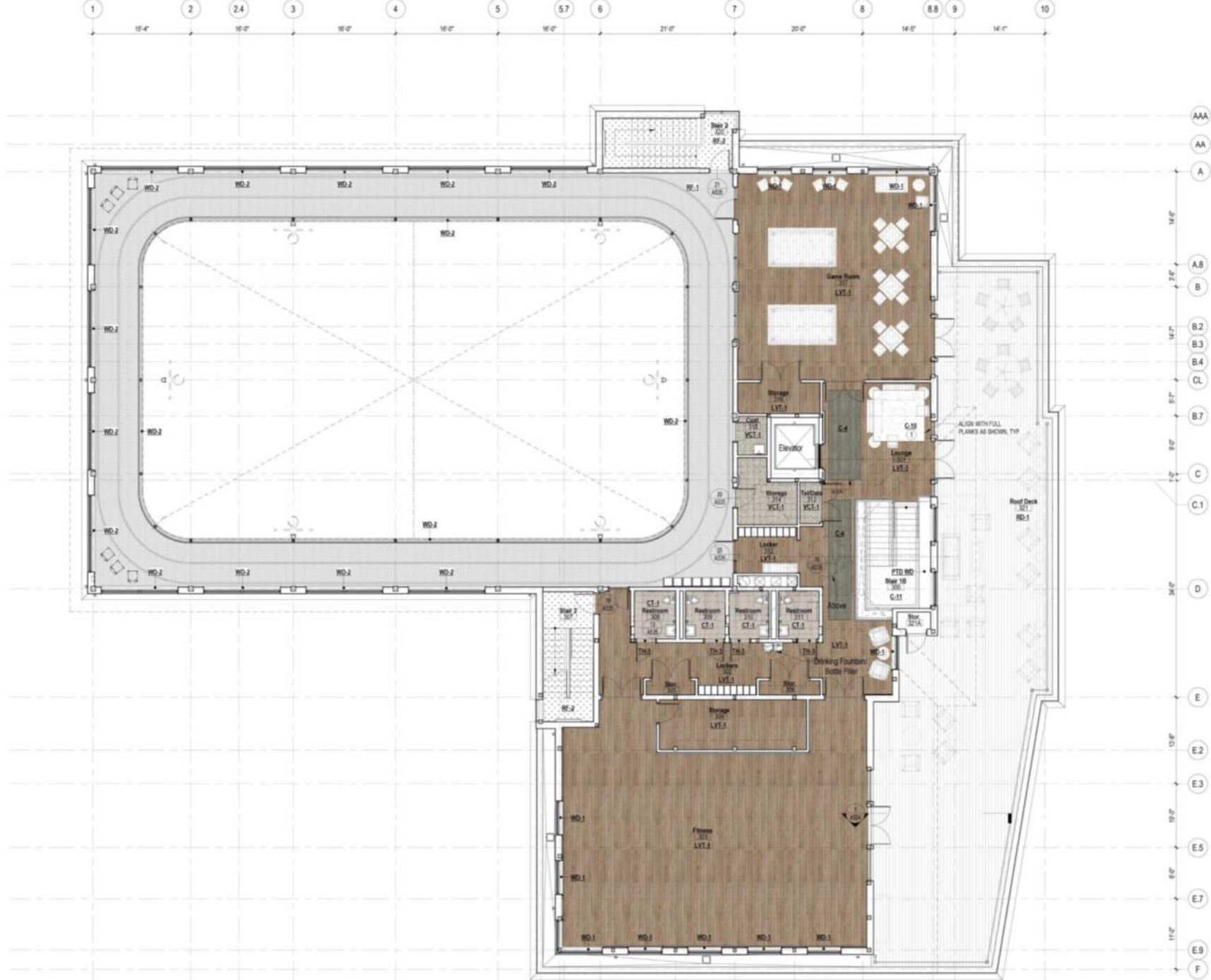

3RD FLOOR FLOOR FINISHES

Used at : White walls
(All)

P-1 Benjamin Moore OC-17
White Dove

Used at : Multiple
Purpose Room Accent
@ Stage

P-4 Benjamin Moore 092
Arizona Peach

Used at : Admin offices

P-7 Benjamin Moore 1626
Gentle Gray

Used at : Common Area
Below Chair Rail and Art
Room Accent

P-2 Benjamin Moore 1577
Arctic Gray

Used at : Library Accent

P-5 Benjamin Moore 1442
Deep Indigo

Used at : Art room

P-8 Benjamin Moore OC-68
Distant Gray

Used at : Reception
Area Accent

P-3 Benjamin Moore 720 (New option)
Bella Blue

Used at :-

P-6 Benjamin Moore 1598
Silver Lake

Used at : Second Floor
Accent

P-9 Benjamin Moore 1280 (New option)
Burgundy Rose

Used at : Corridor
Accent wall

P-10 Benjamin Moore 218
Beach Haven

Used at : Restroom
(2nd Floor)

P-11 Benjamin Moore 961
Seapearl

Used at : Restroom
(1st and 3rd Floor)

P-15 Benjamin Moore 880
White Zinfandel

Used at :
Third Floor Accent

P-13 Benjamin Moore 305
Country Comfort

Used at :
Third Floor Accent
(Alternative Option)

P-13 Benjamin Moore CSP-950 Honeybee

Used at : Game and
Fitness Room

P-14 Benjamin Moore CST-845 Lime Sherbet
(option TBD)

Used at : Admin office
(Alternative Option)

P-7 Benjamin Moore 1494 (New option)
Vale Mist

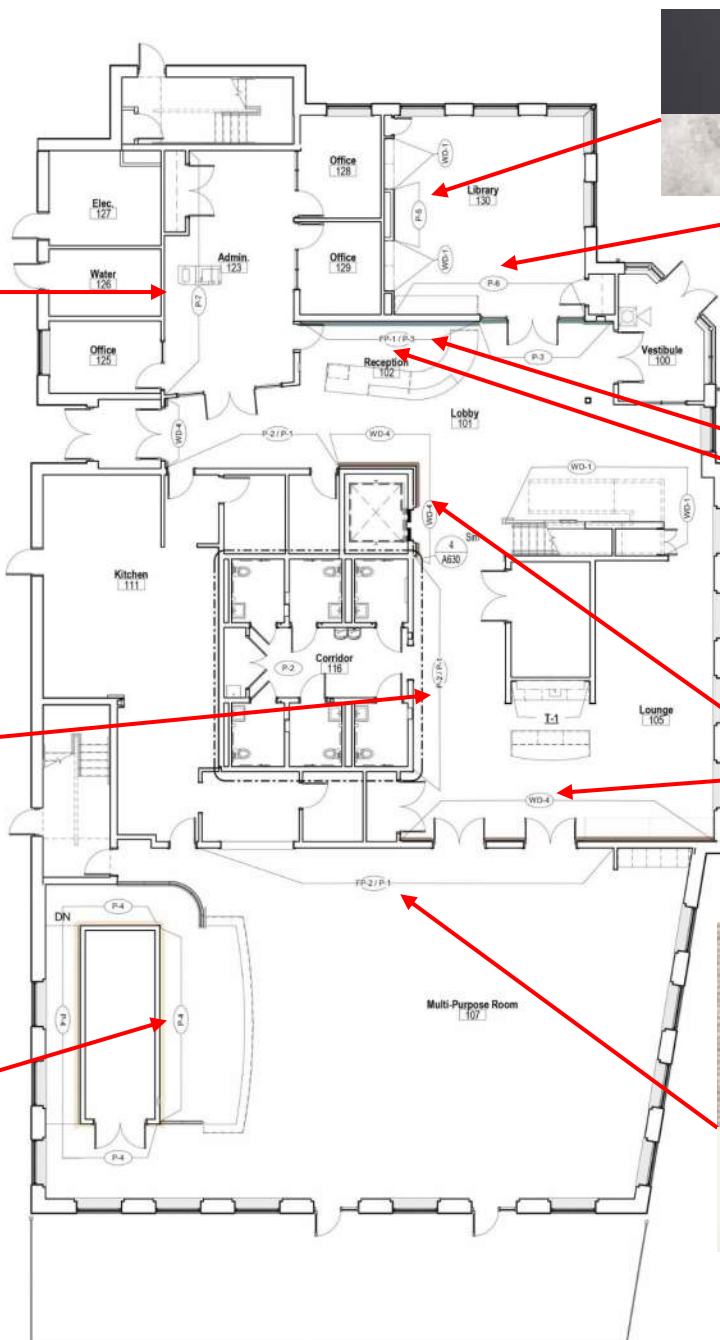

Used at : Library
Bookshelf wall Accent



Used at : Library
Accent

Used at :
Admin
Accent



Used at :
Reception Desk
area

Used at : Common wall,
Below Chair rail

Used at : Common wall,
Above Chair rail

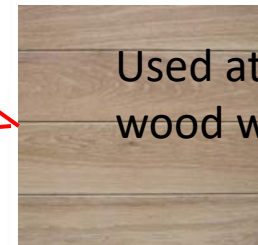

Used at : Elevator
wood wall Accent

Used at : MPR Stage
Wall (Accent)

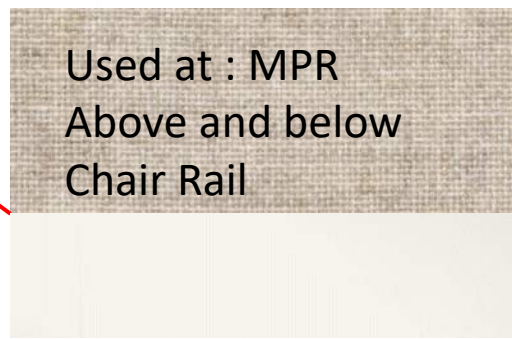

Used at : MPR
Above and below
Chair Rail

1ST FLOOR WALL FINISHES

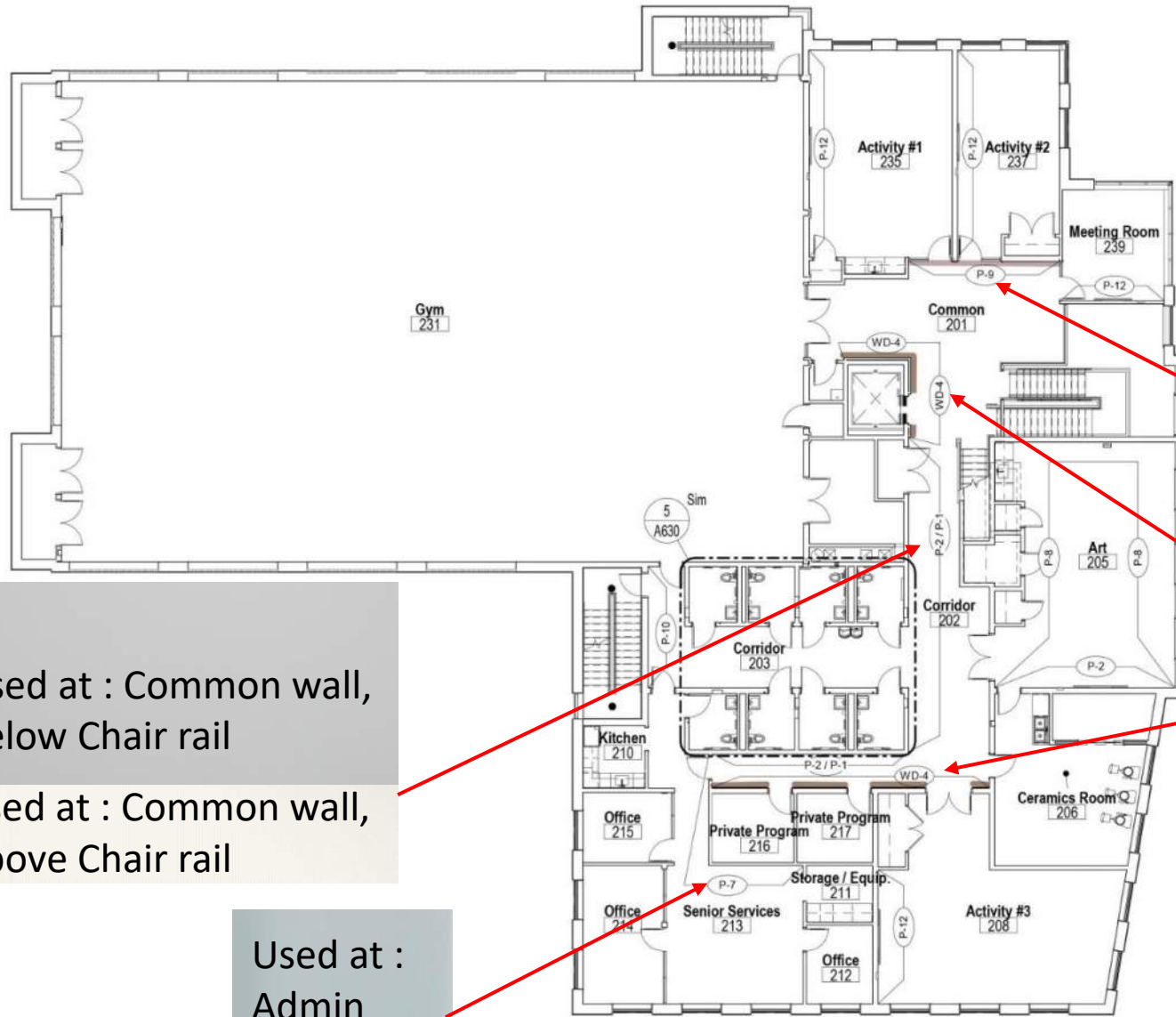

Used at : Common wall,
Below Chair rail

Used at : Common wall,
Above Chair rail

Used at :
Admin
Accent

Used at : Wall
Accent

Used at : Elevator
wood wall Accent

2ND FLOOR WALL FINISHES

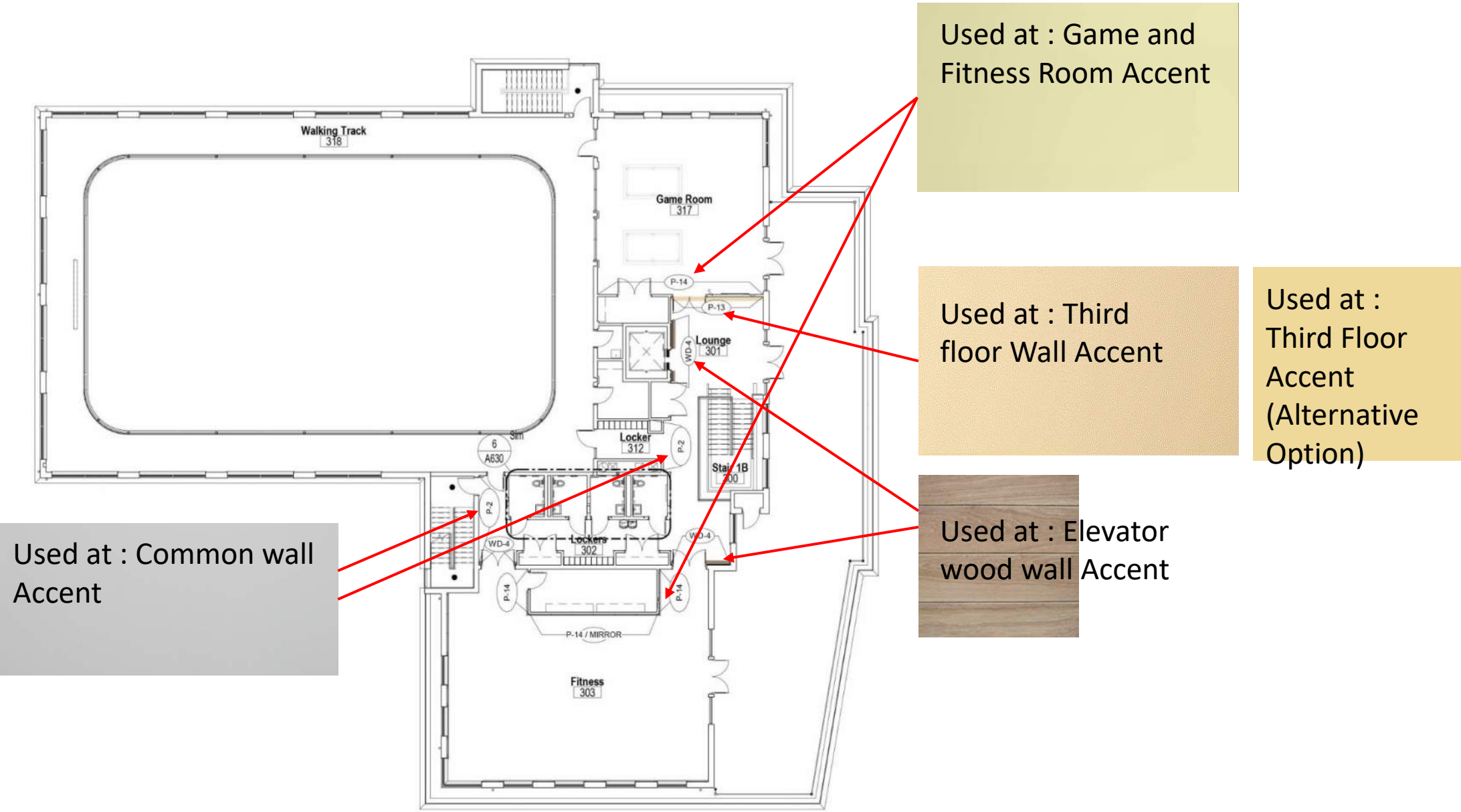

3RD FLOOR WALL FINISHES



Cooper Center for Active Living Finishes

Millwork to Match Control Sample WD-4

Millwork to Match Control Sample WD-4

Millwork to Match Control Sample WD-4

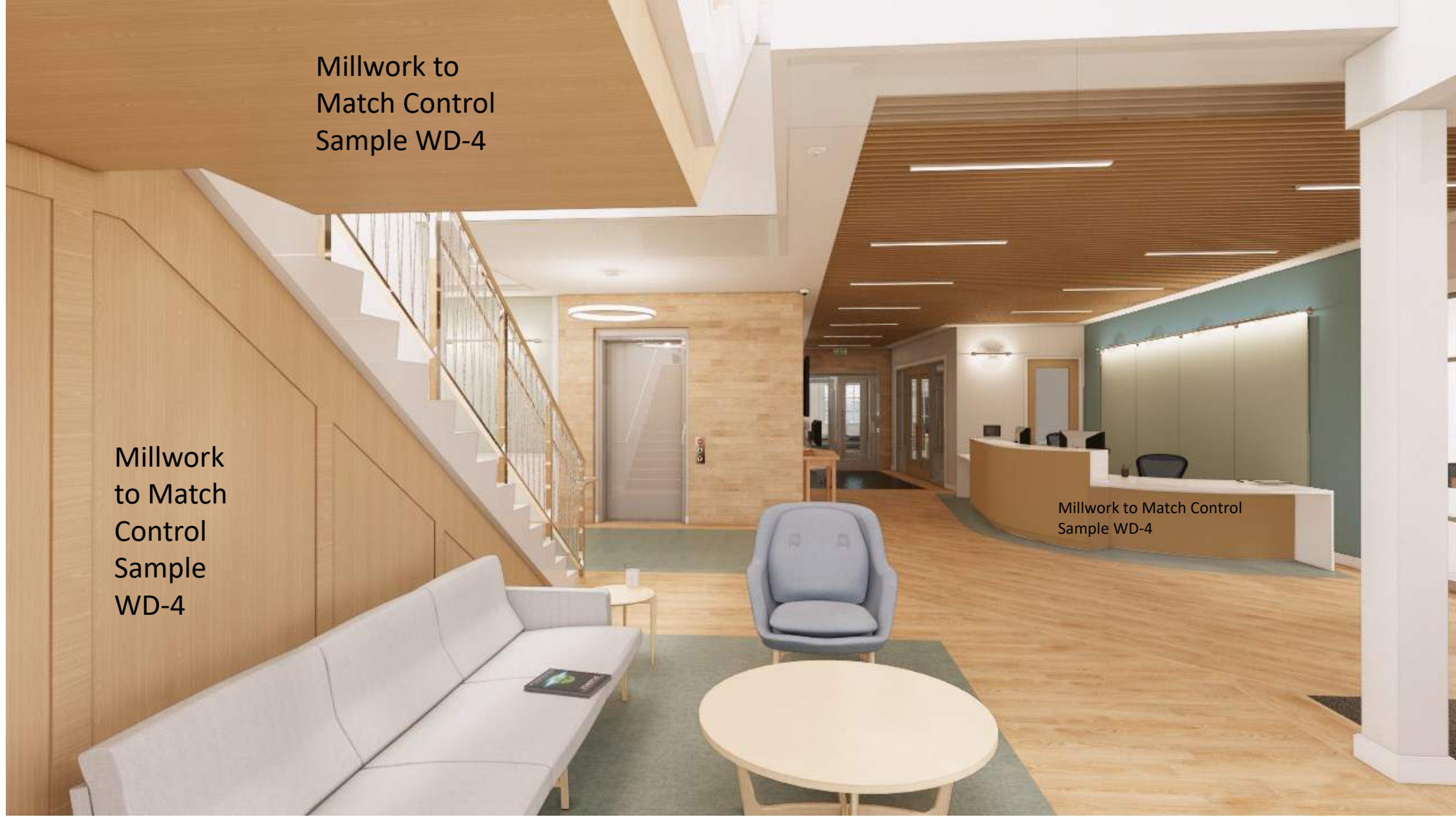



Solid stock wood
window sill to
match control
sample WD-4



Furniture fabric and area rug in FF&E (rendering to be updated)





Furniture fabric and area rug in FF&E (rendering to be updated)

See Third floor carpet sample (rendering to be updated)

